

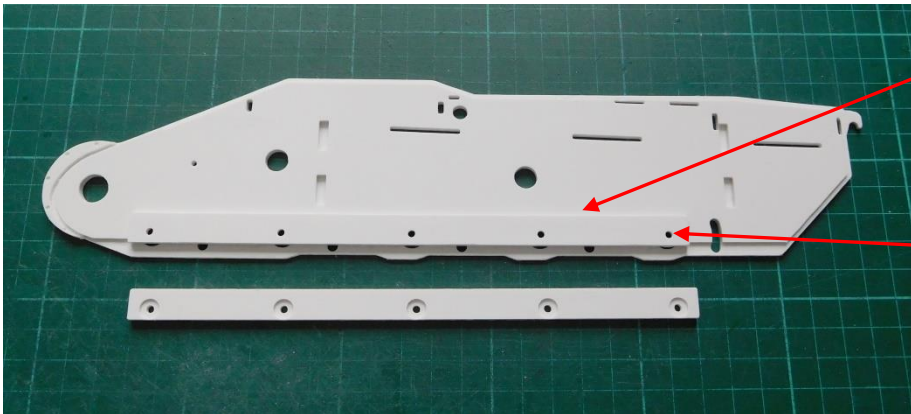

Unterwanne / lower hull

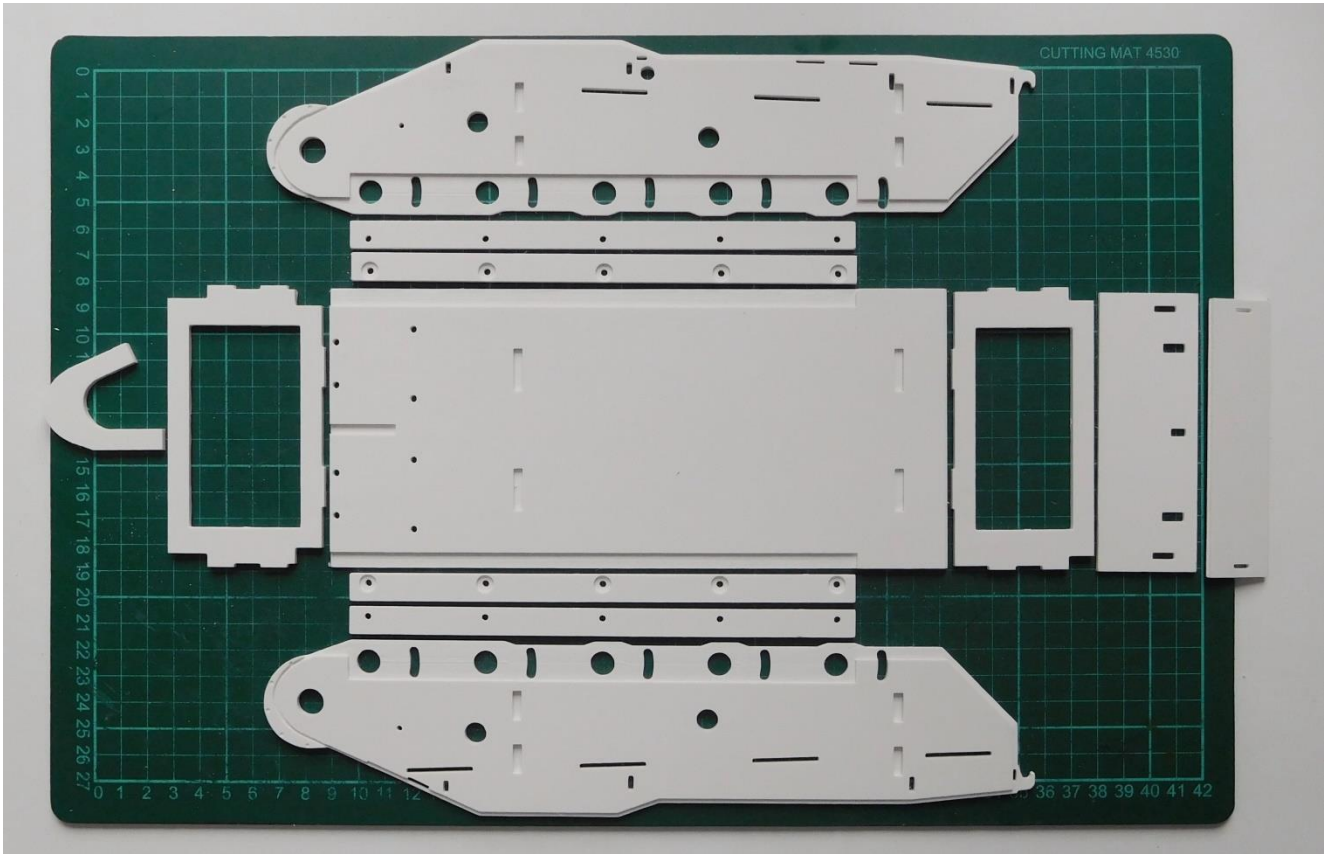

Leiste oben anliegend /
no gap

Senkungen nach außen
gerichtet / counter sunk
heading outside

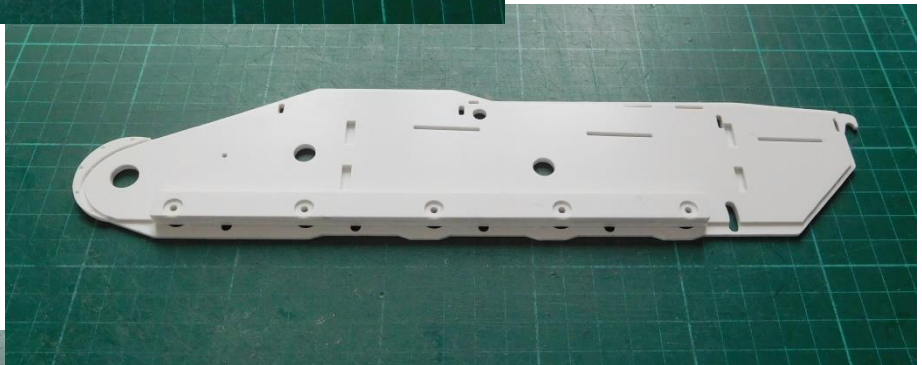

Bohrungen zentrisch / centric holes

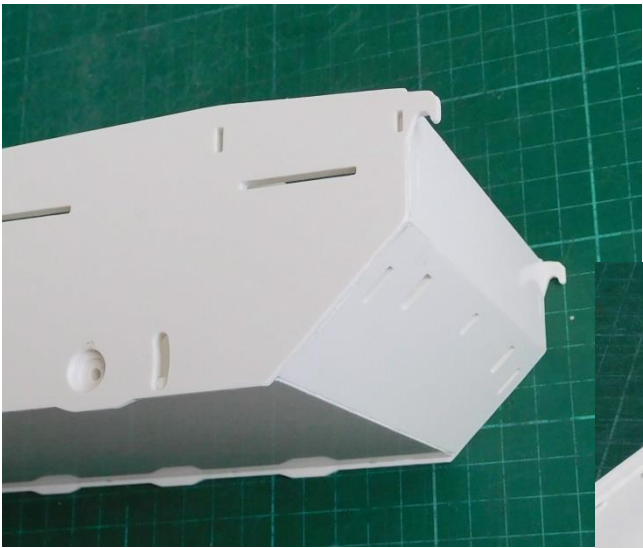
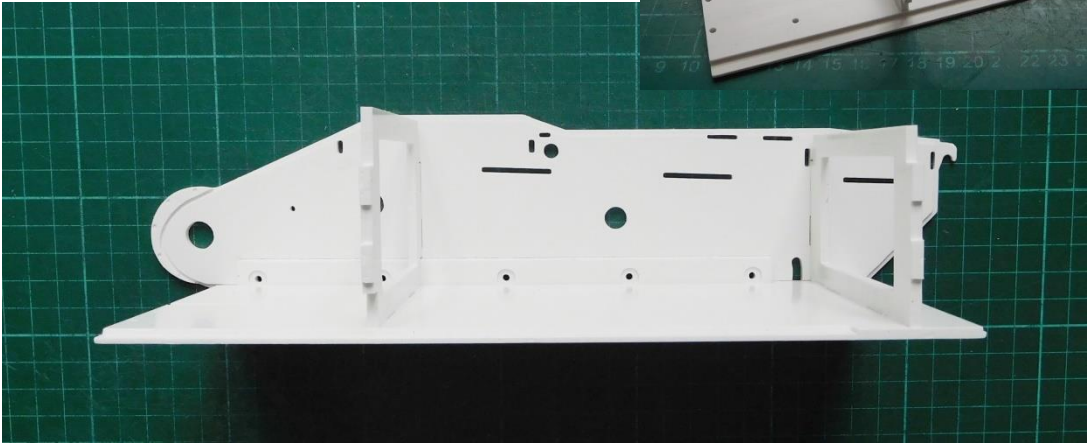
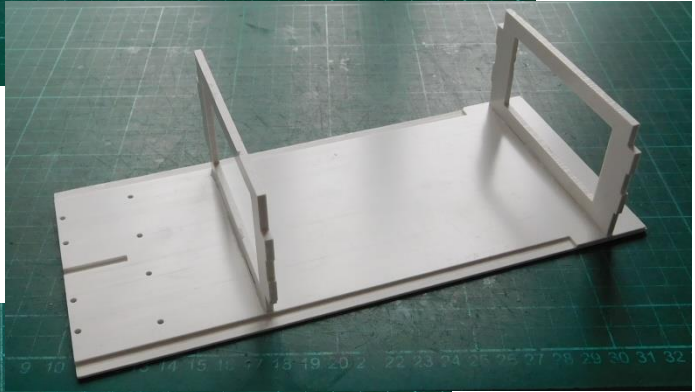
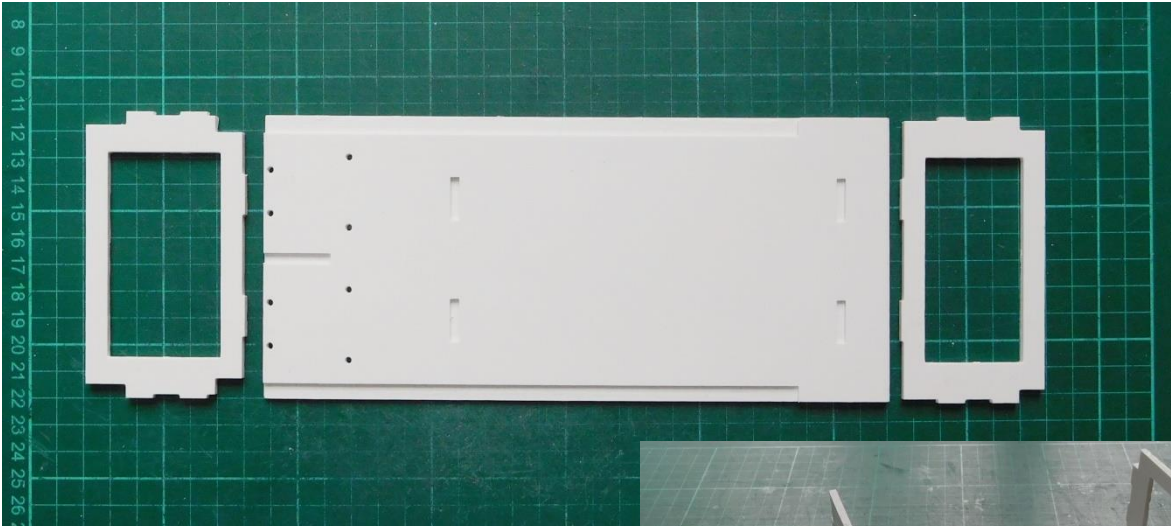

**Innere Stirnflächen bündig /
inner surfaces should match**

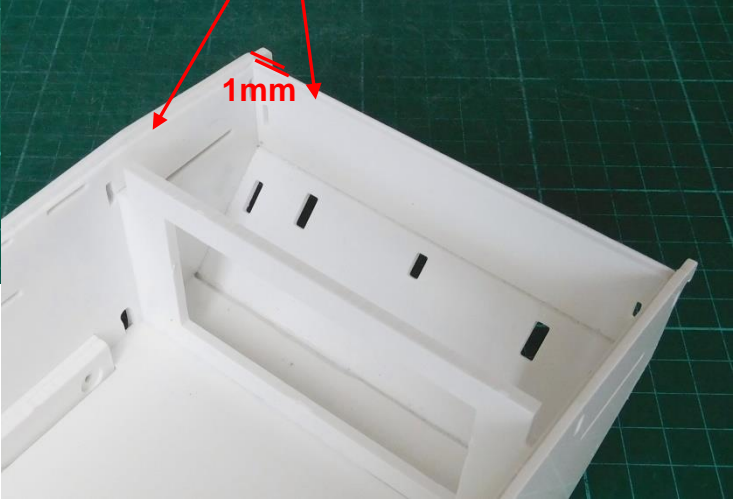

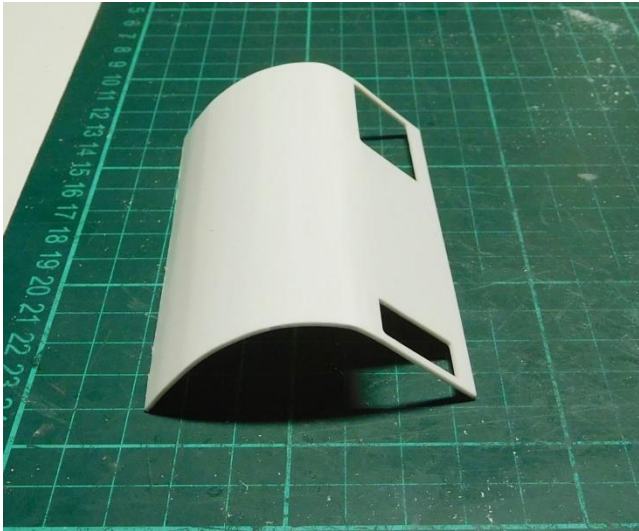

**Stirnflächen innen bündig /
inner surfaces should match**

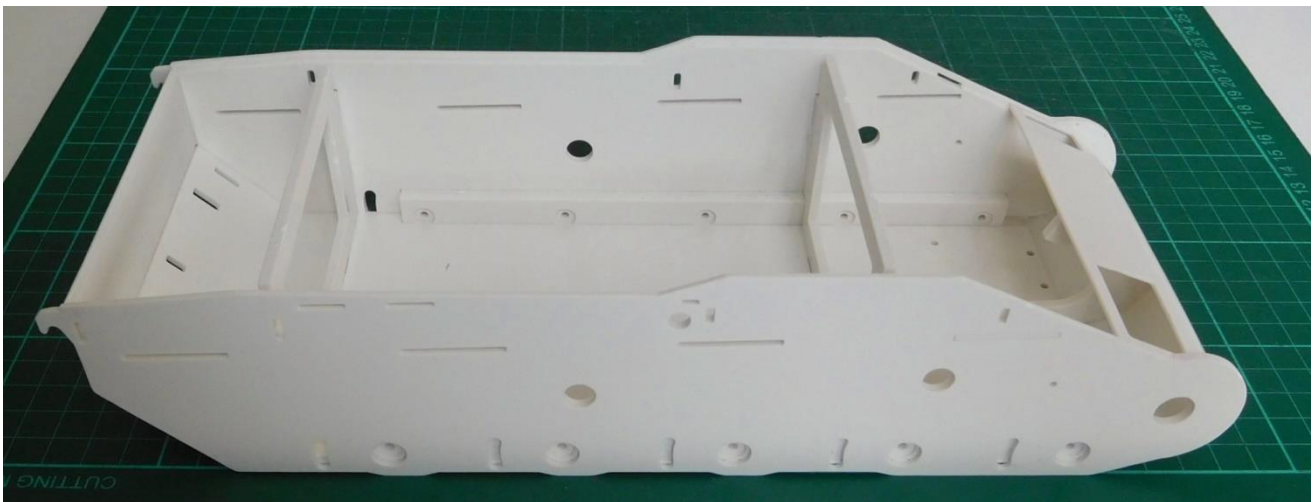
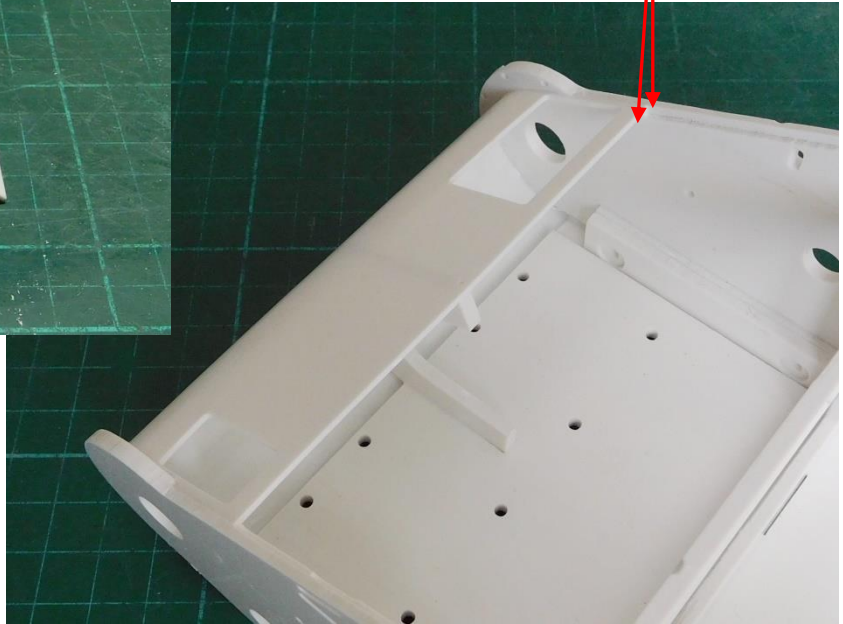

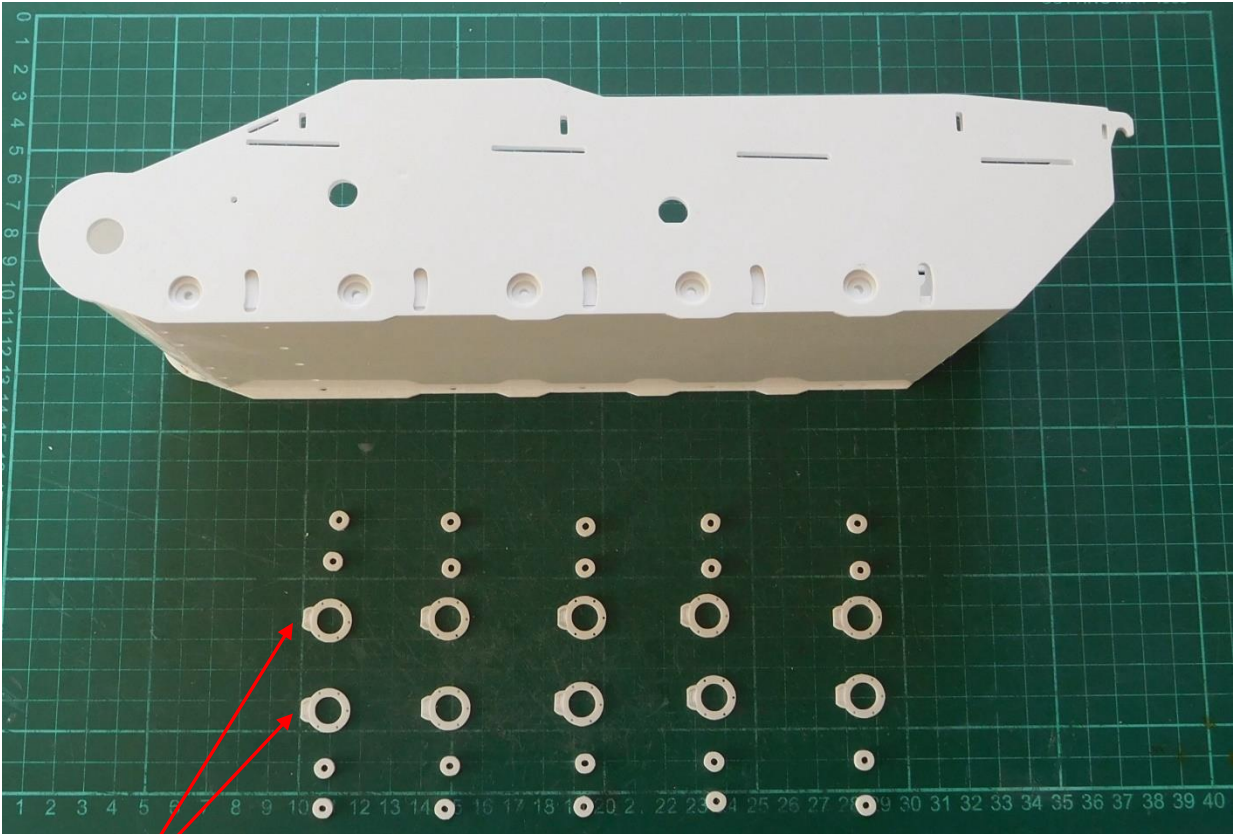

**Beidseitig nach vorne gerichtet /
heading forward on both sides**

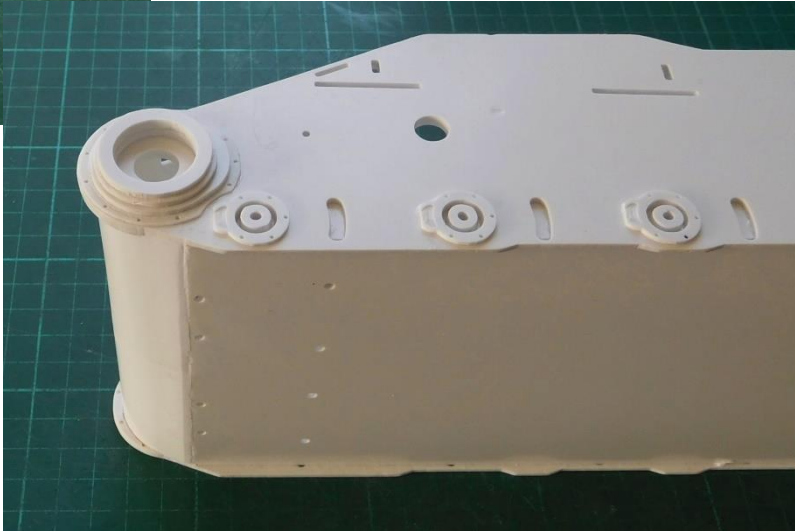

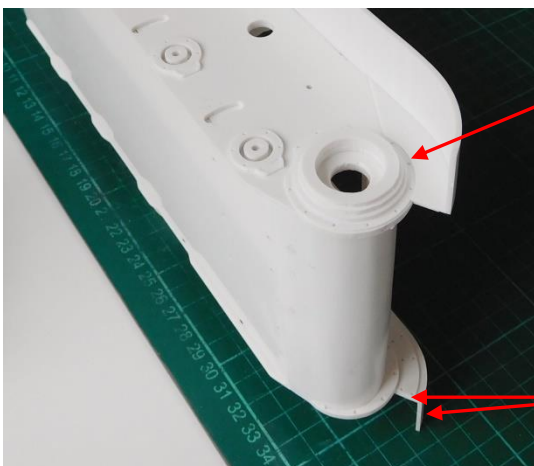
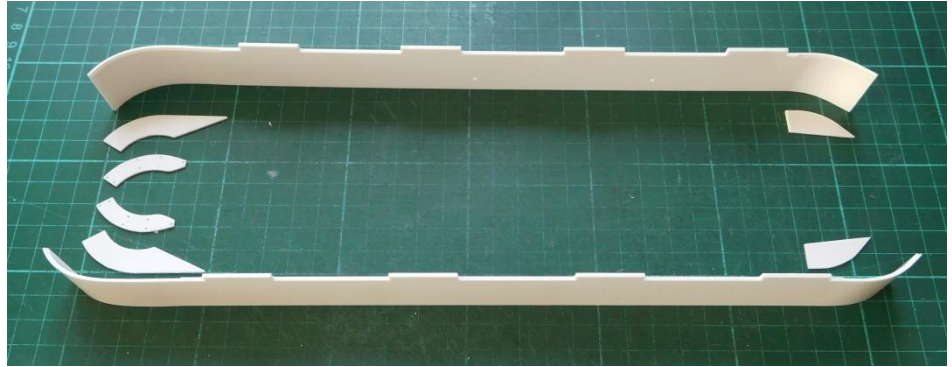
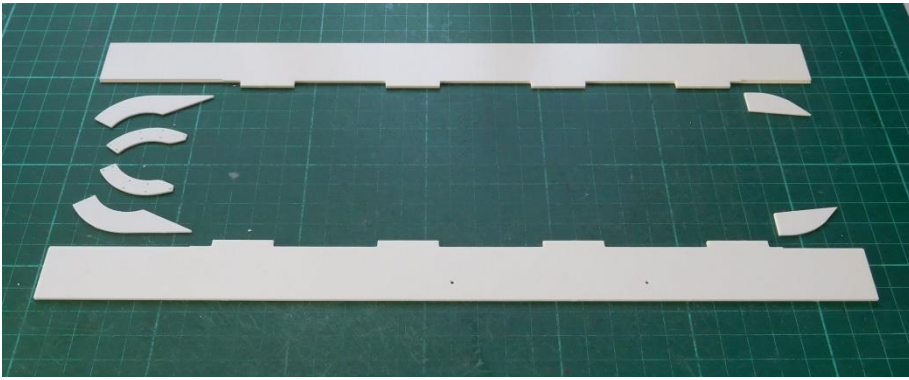

**Rundung zentrisch mit Vorgelege-Ringen /
centricity of sheet and rings**

**Stirnflächen bündig /
front surface should
match**

Laufwerk / suspension

**Panzer III Schwingen-Set mit Schrauben und Torsionsfedern /
Panzer III Suspension set incl. springs and screws**

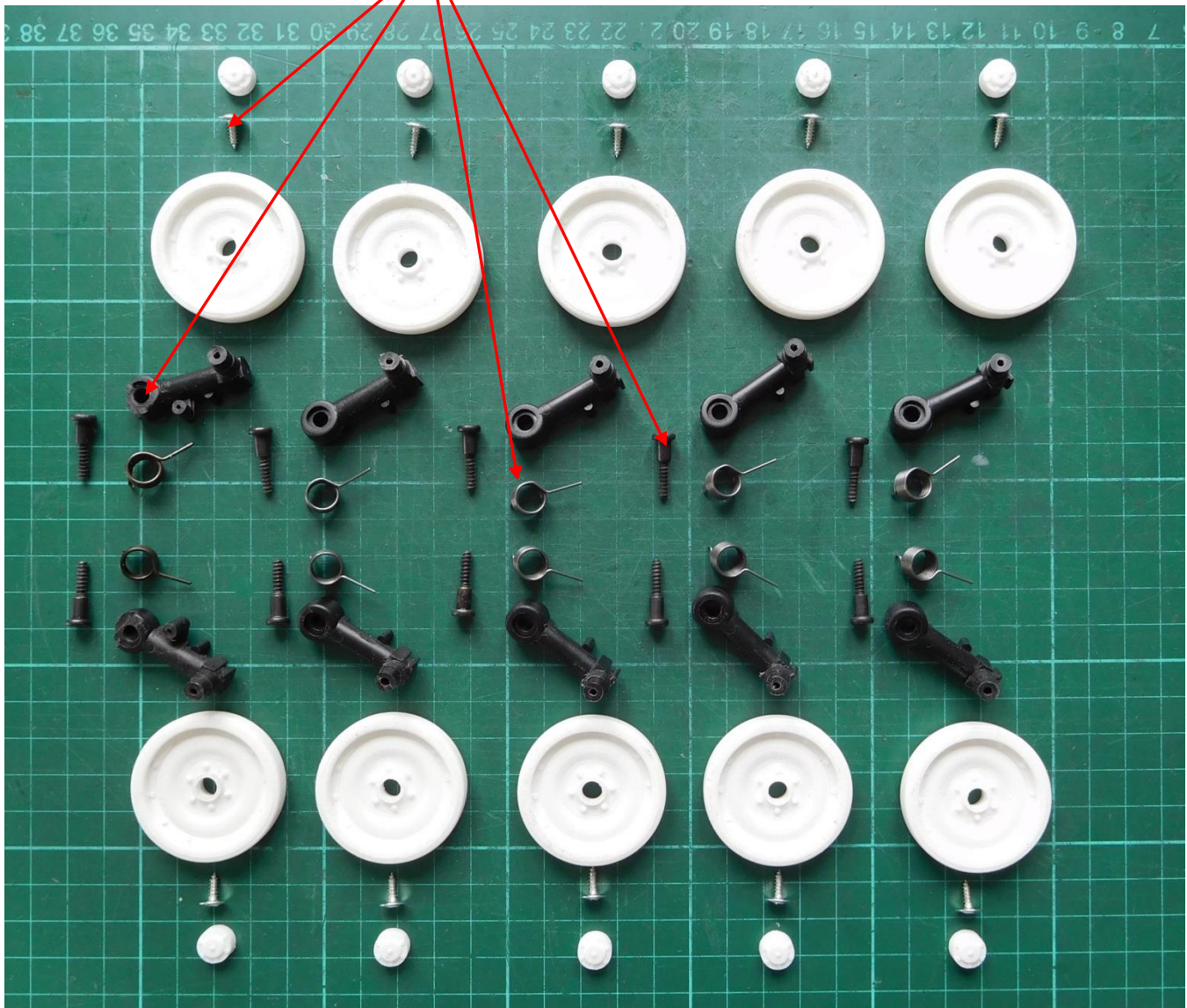

**Schwingenbolzen
bündig kürzen /
cut until both
surface matches**

**Frontschwinge bis
Schraubenkopf und 3mm
tief ausschneiden / (only)
front bogie cutaway until
screw head, depth 3mm**



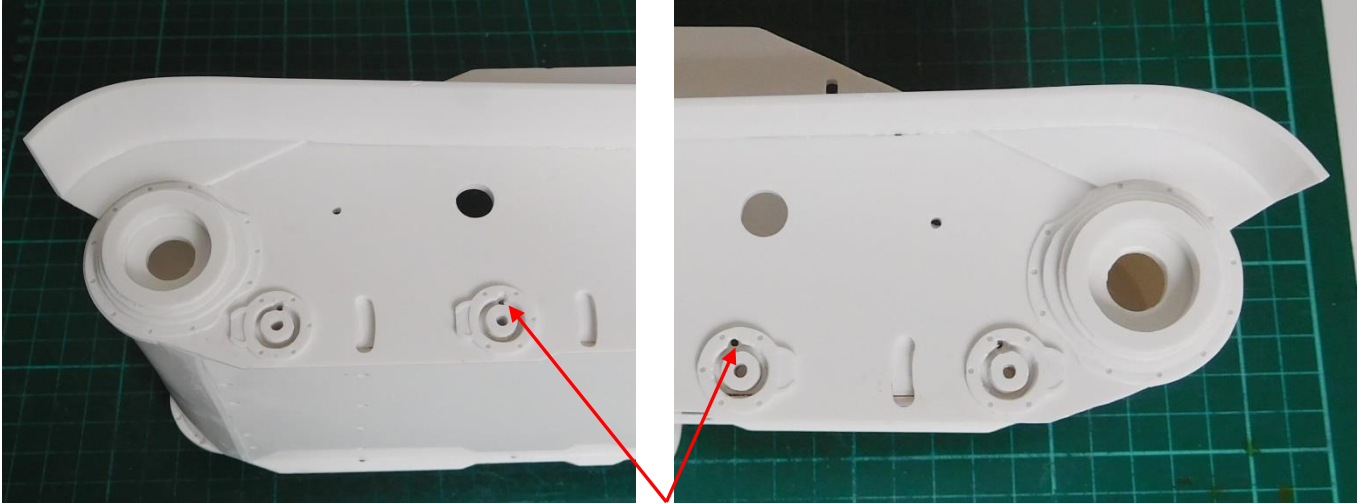

**2mm Löcher leicht zurückhängend für Torsionsfedern /
2mm holes for springs heading slightly backwards**

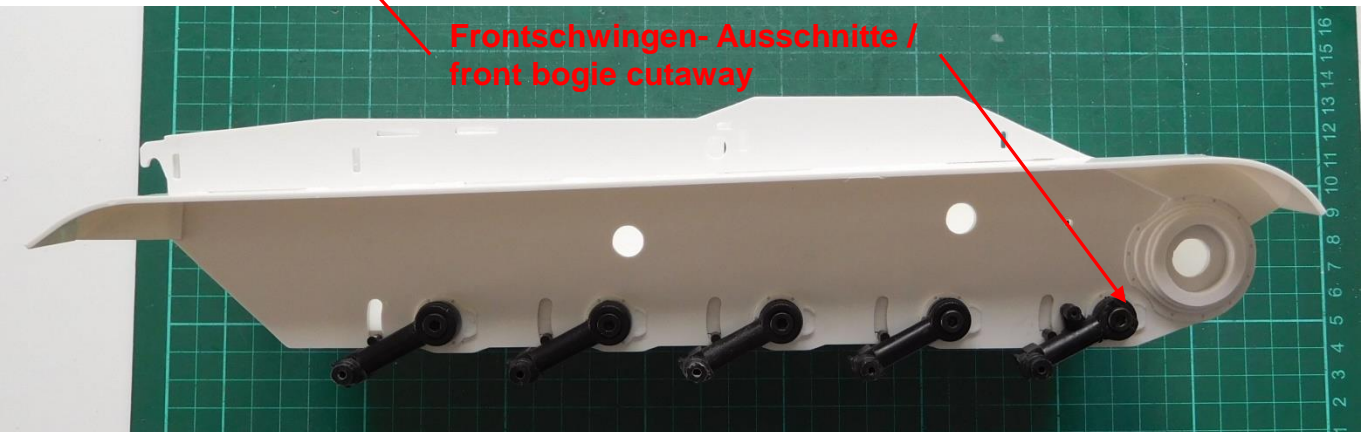
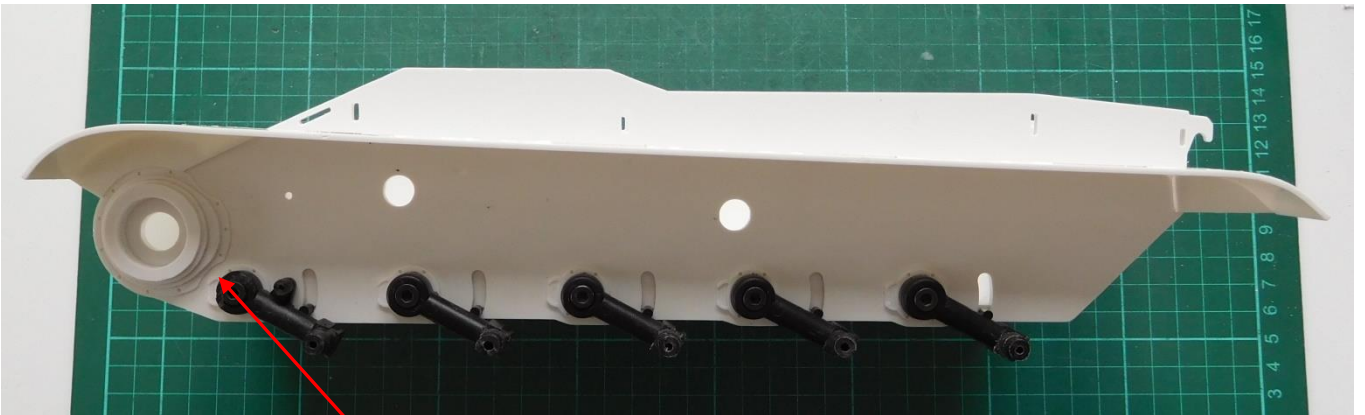
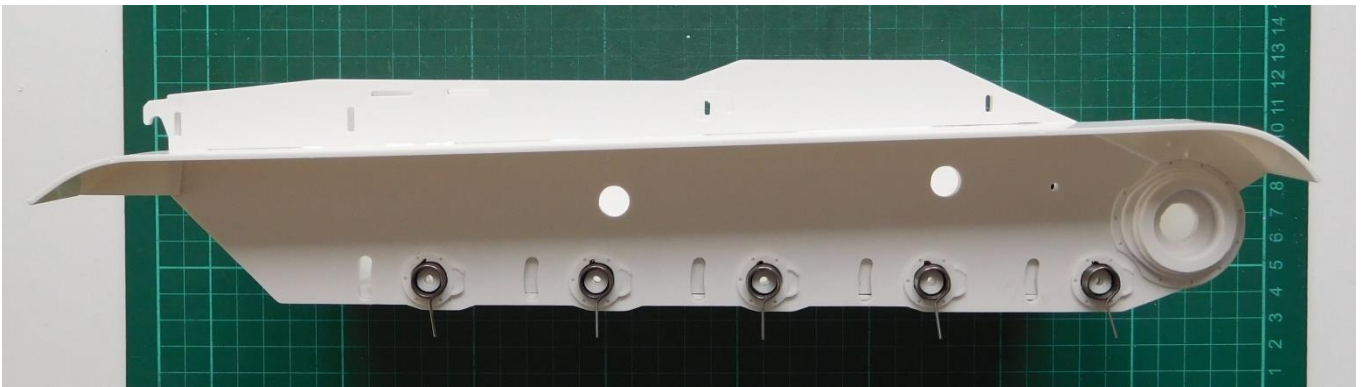

**Frontschwingen- Ausschnitte /
front bogle cutaway**

Stützrollen und Stoßdämpfer / return rollers and bumpers

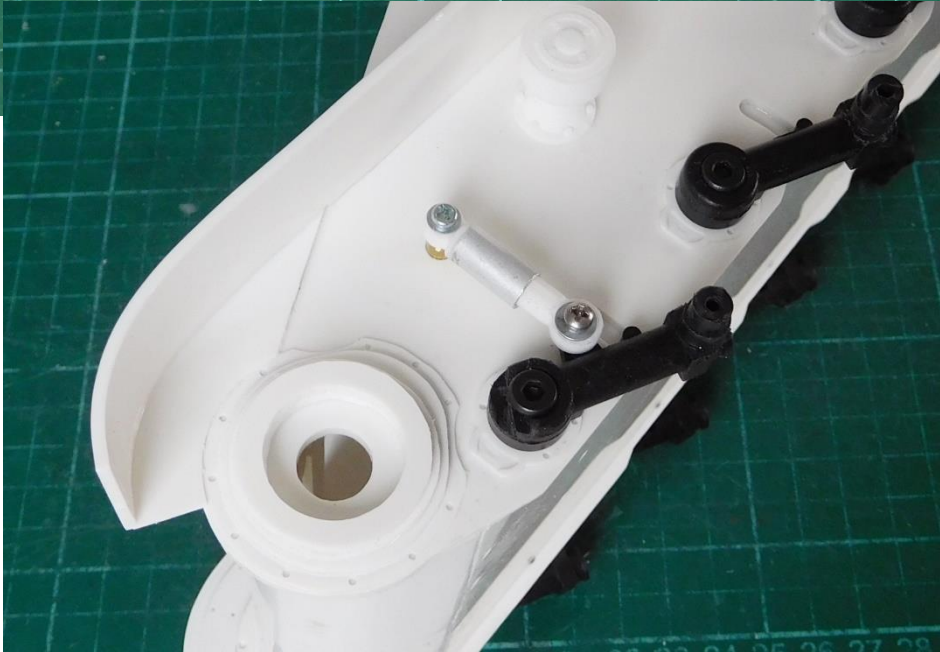
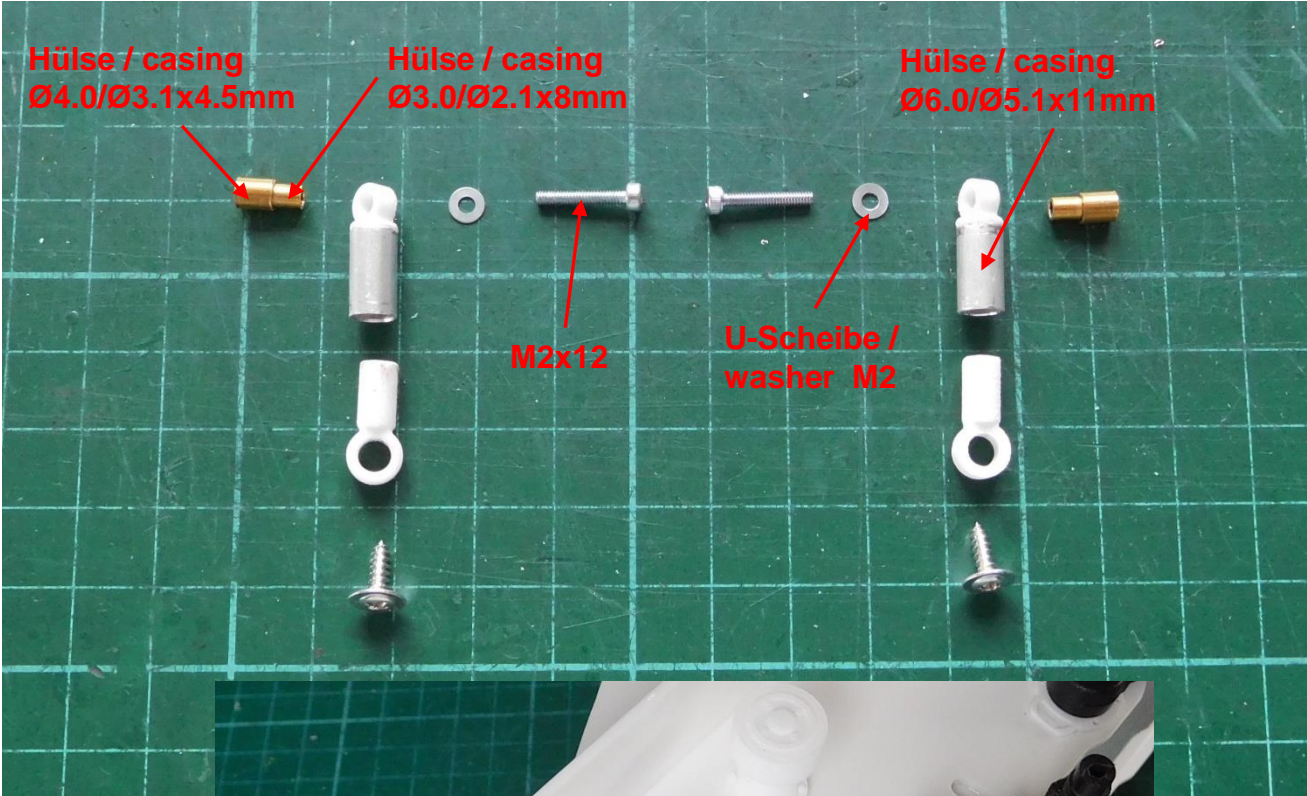
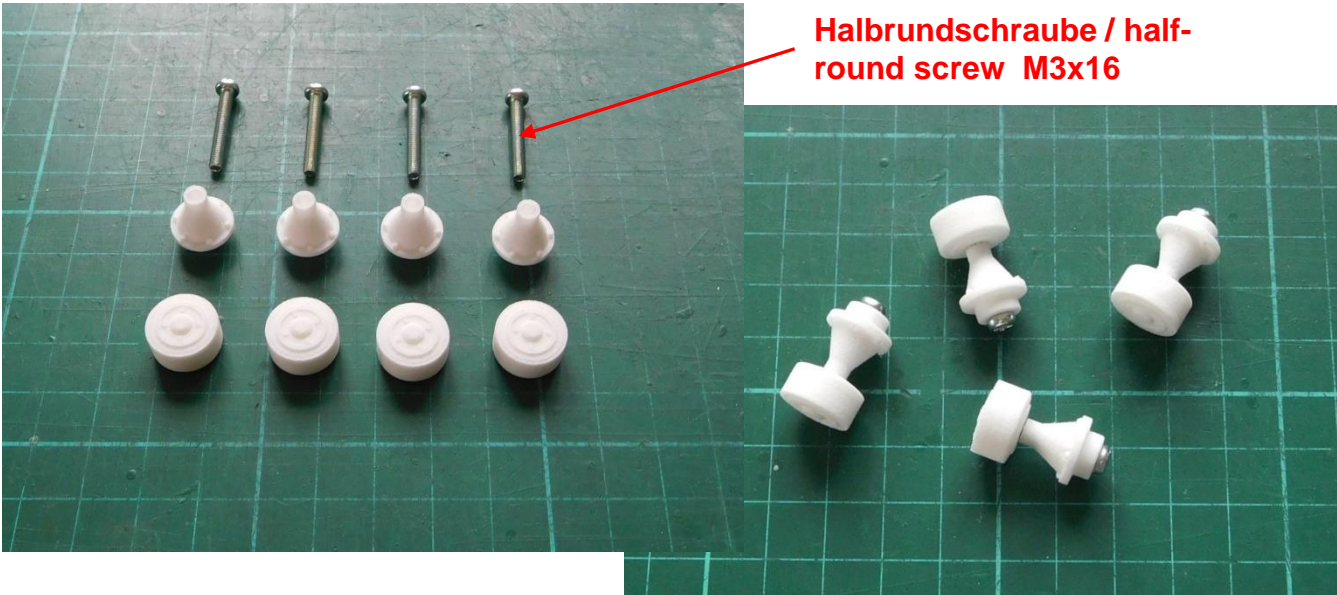

Leitrad / idler wheel

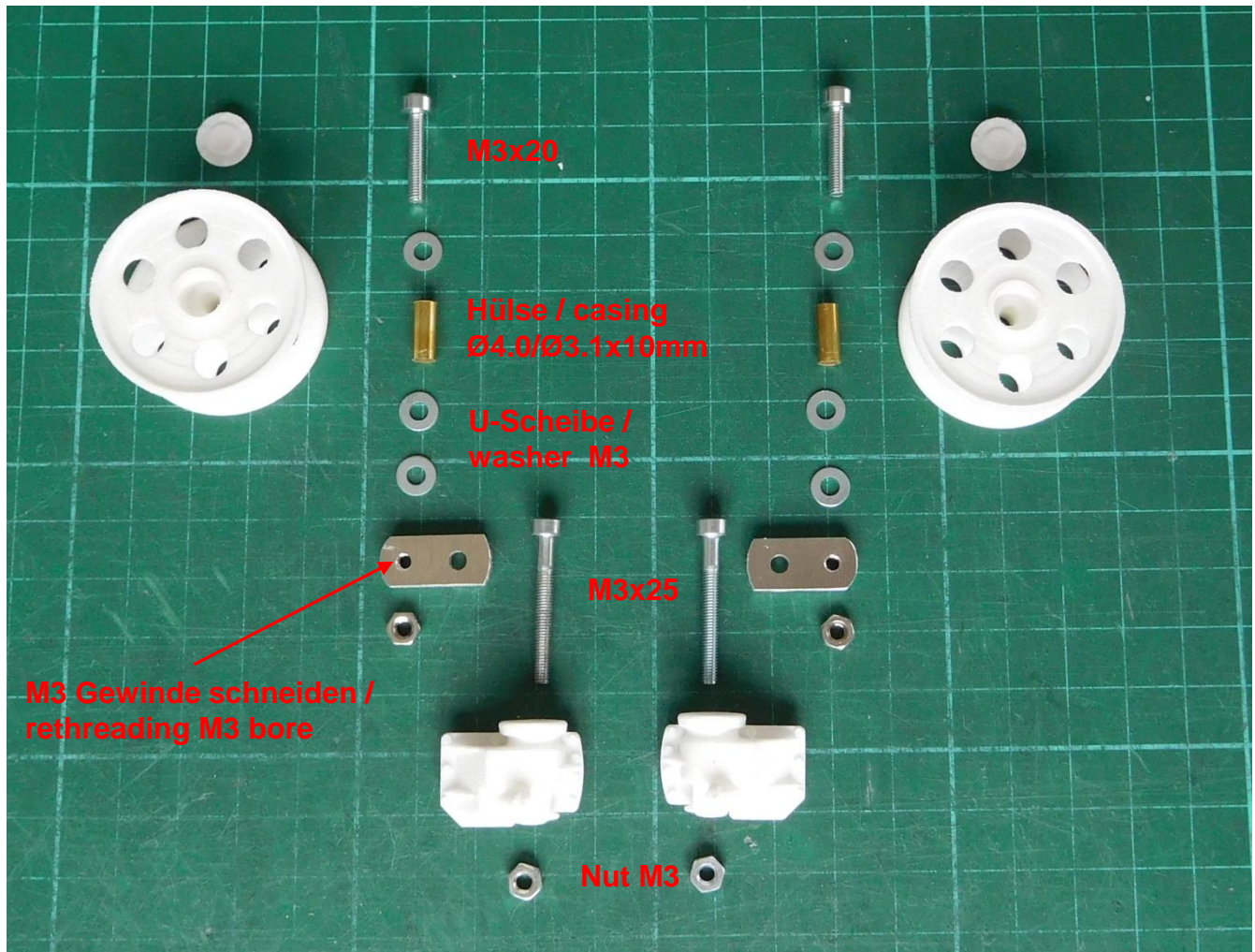

Seitenkästen / stow boxes

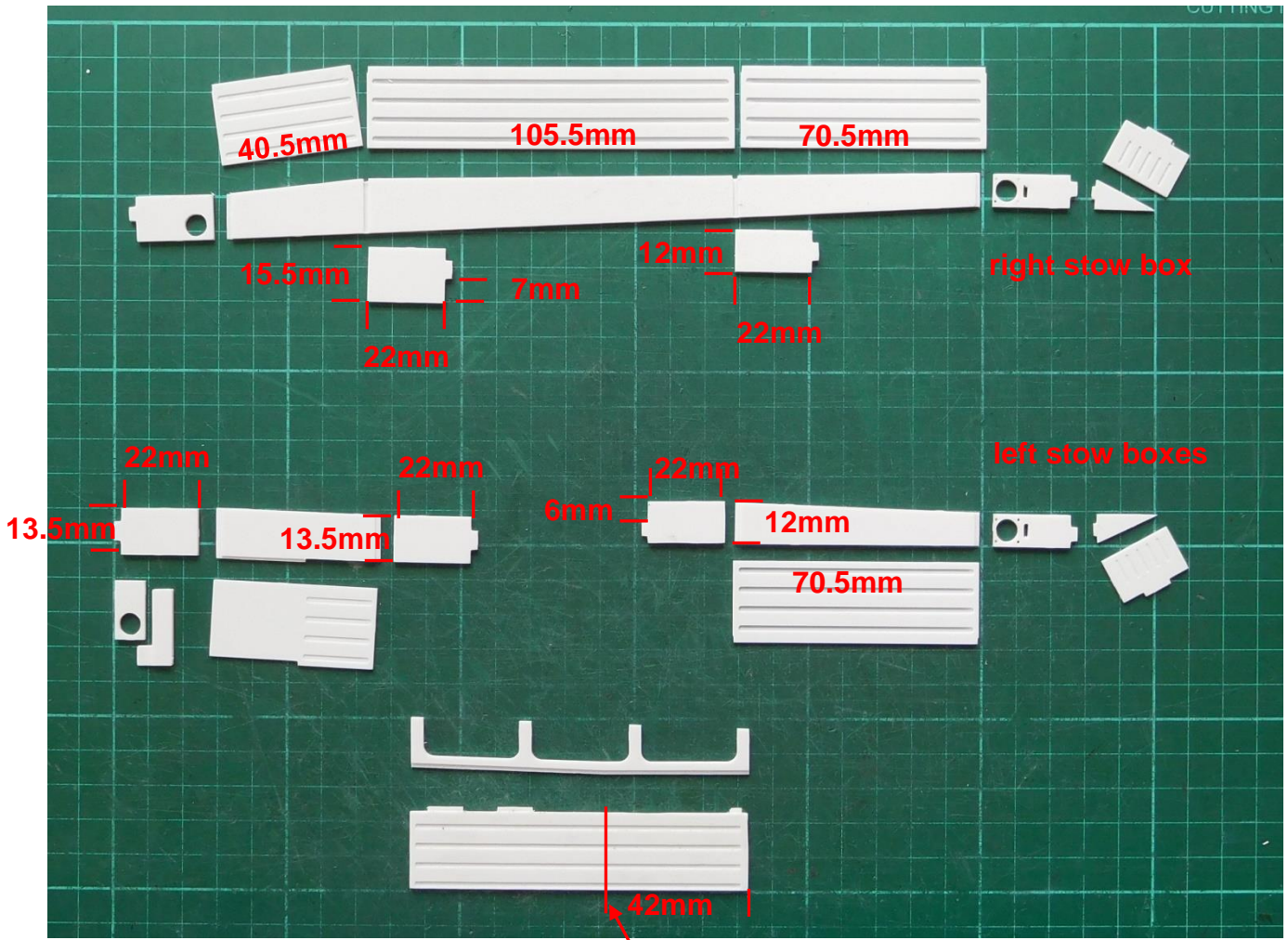

Leicht knicken / slightly bending

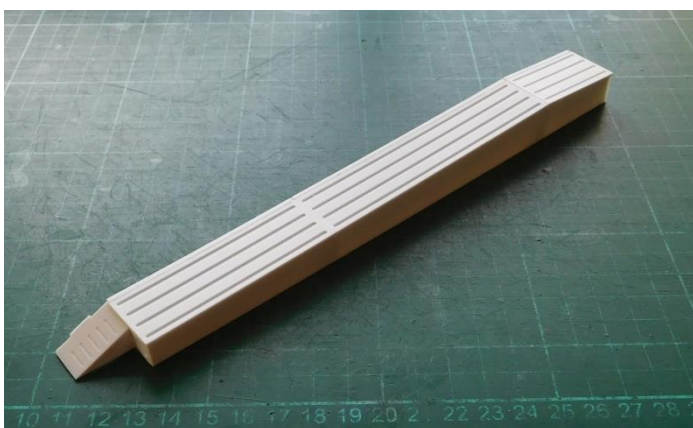
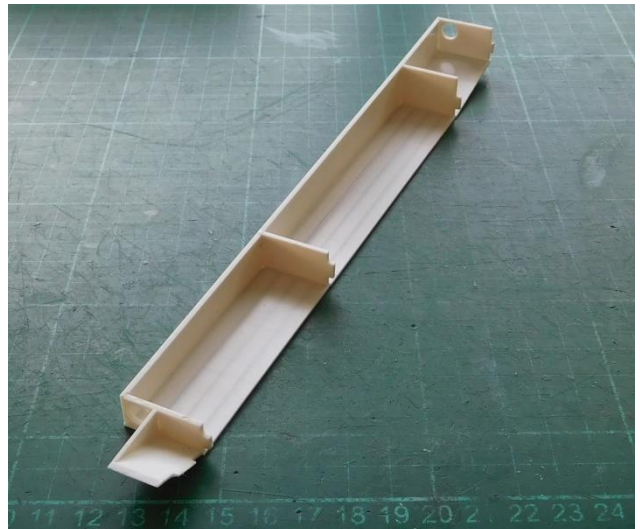
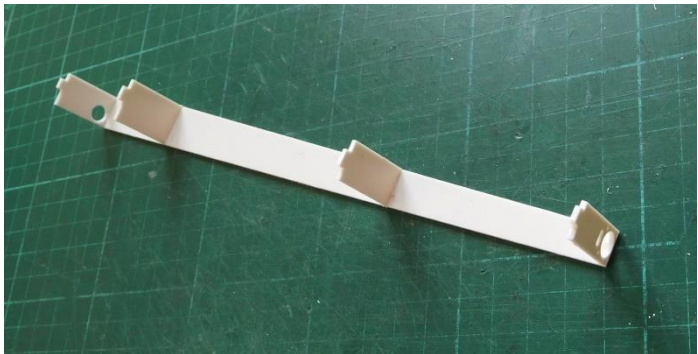

Seitenkästen links / left stow boxes

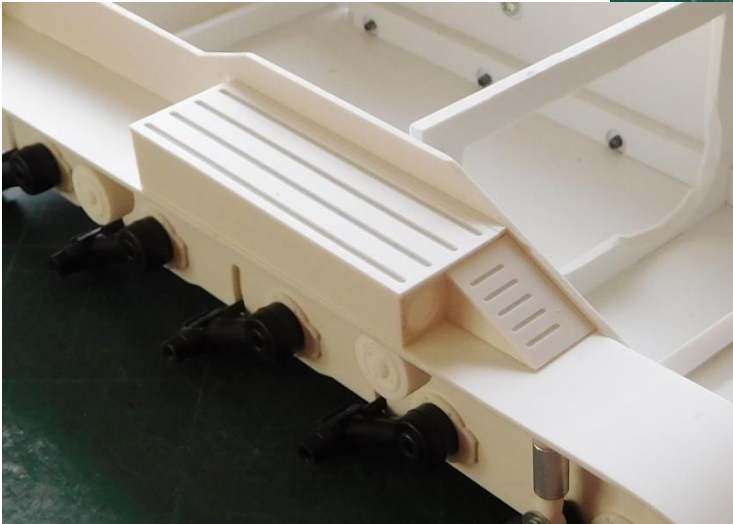
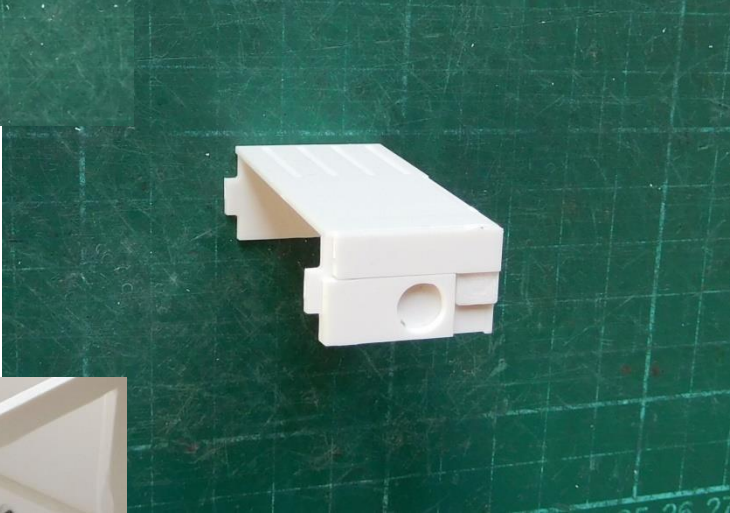
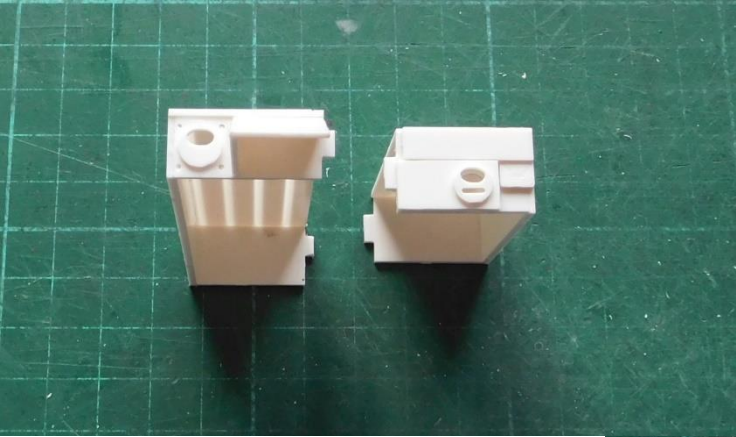

Auspuff / muffler

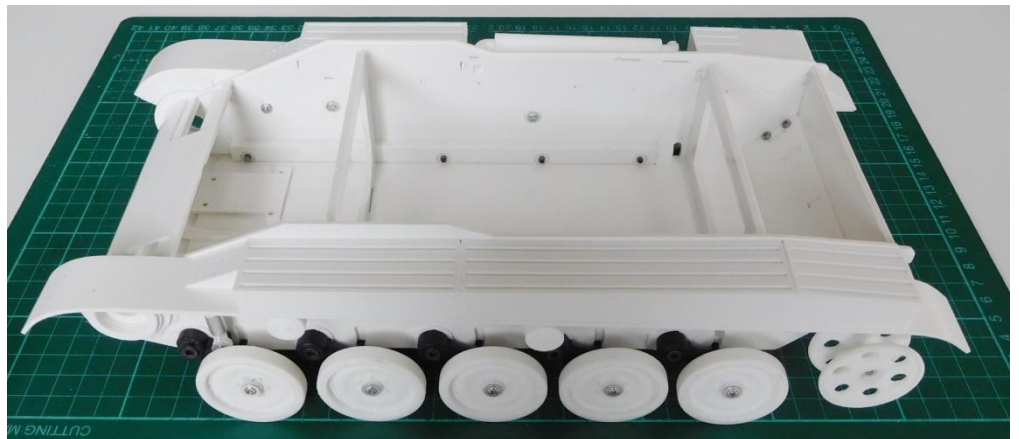
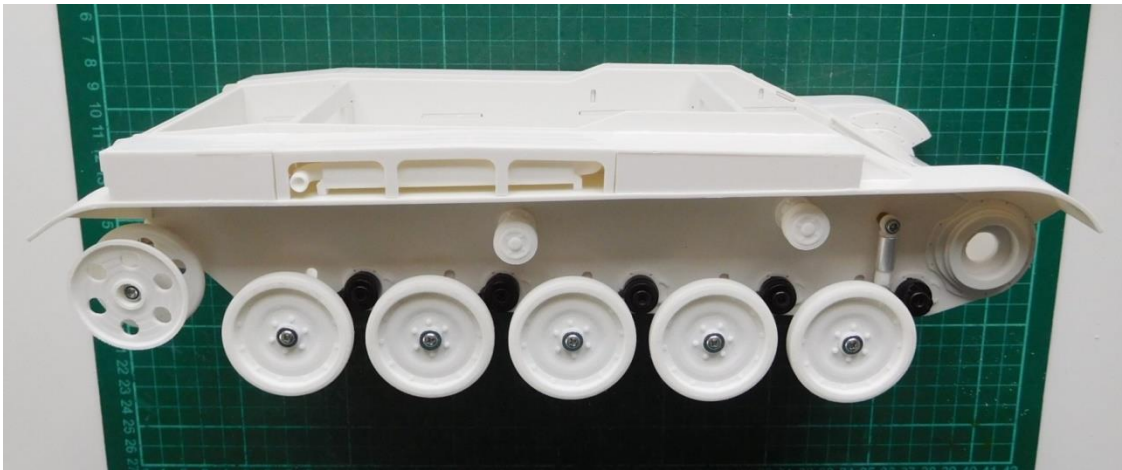
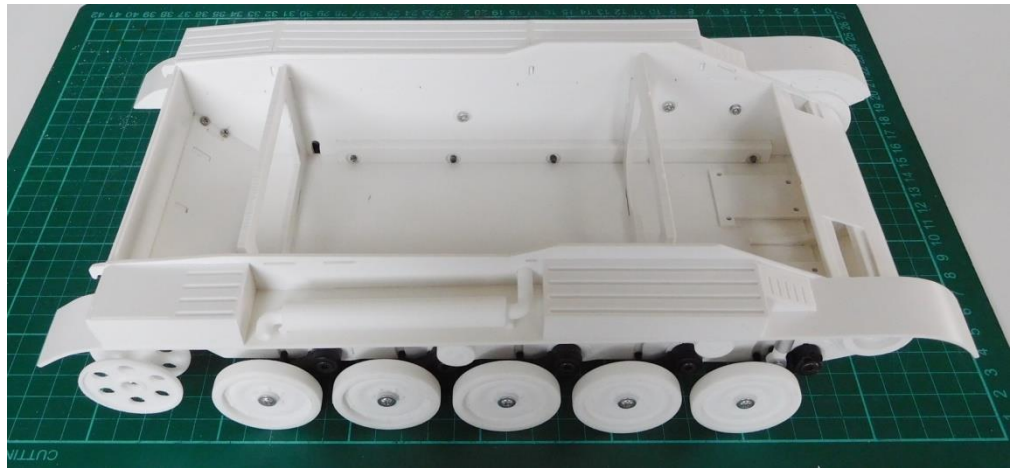
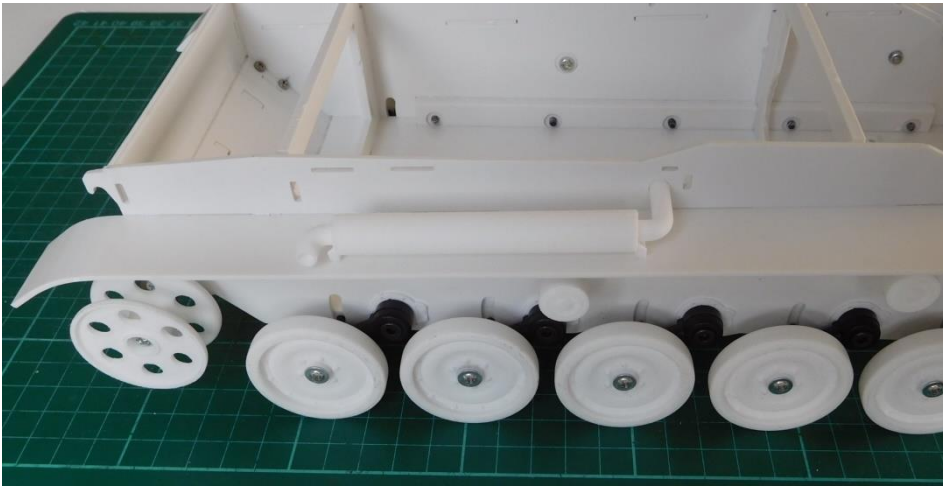

Details an Unterwanne-Rückseite / detail parts of lower hull (backside)

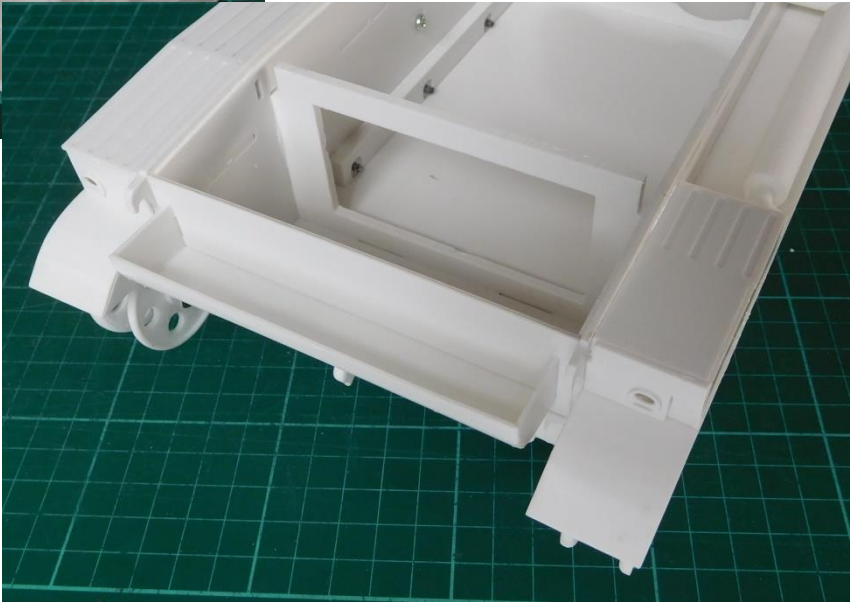
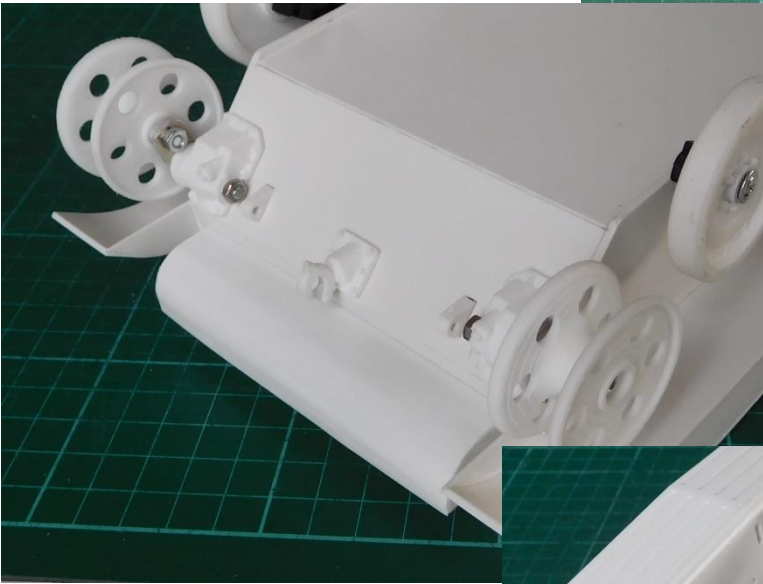
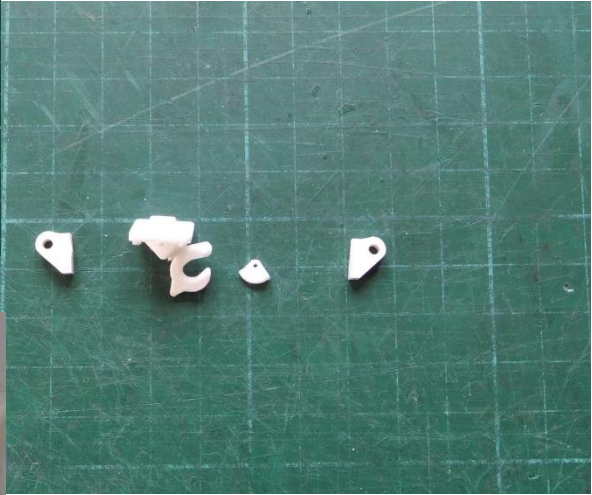

Details am Wannenbug / detail parts at hull front

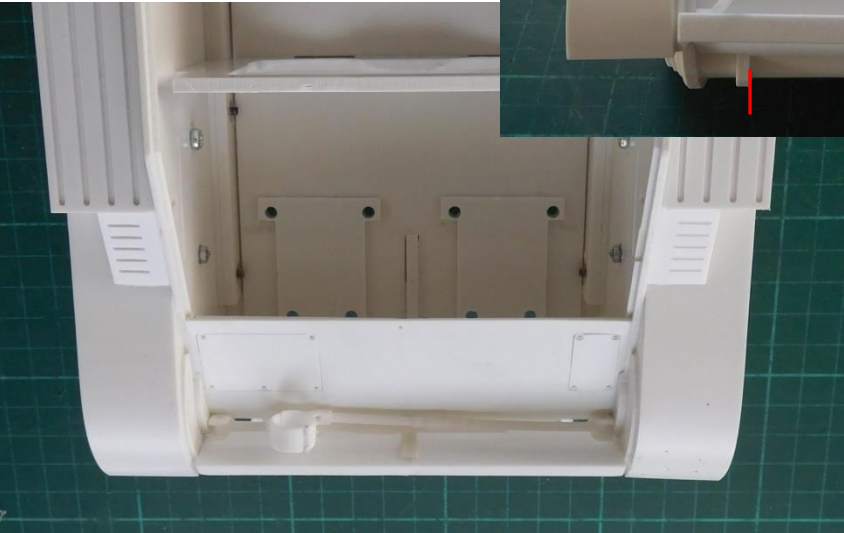
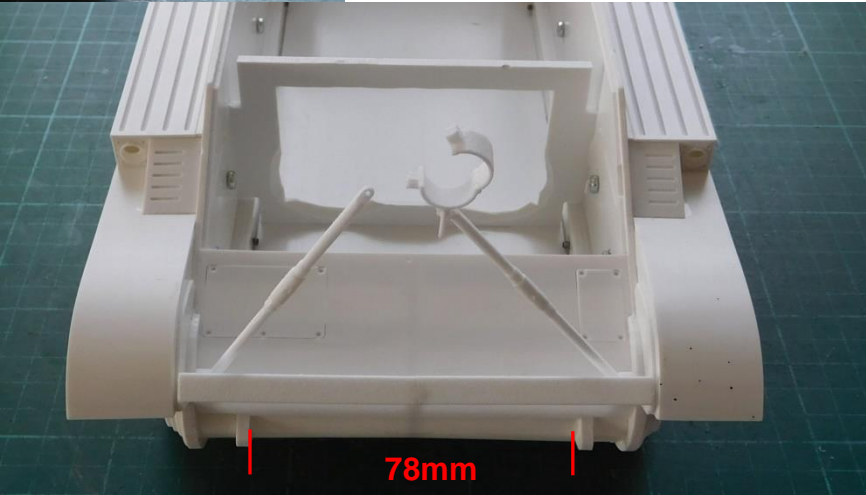
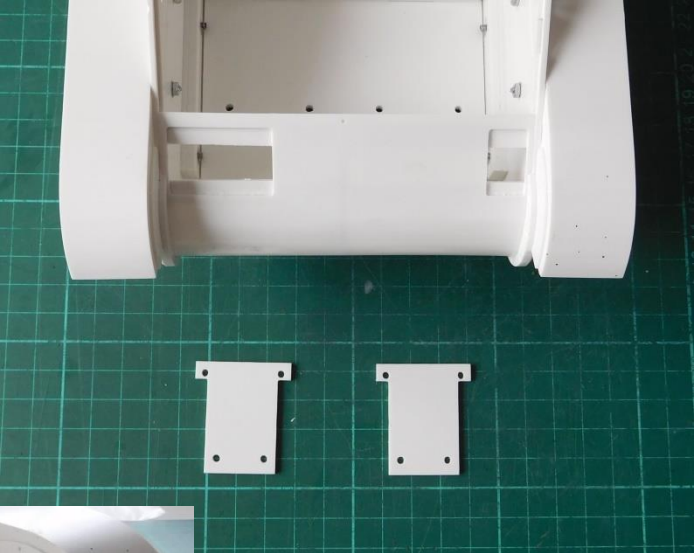
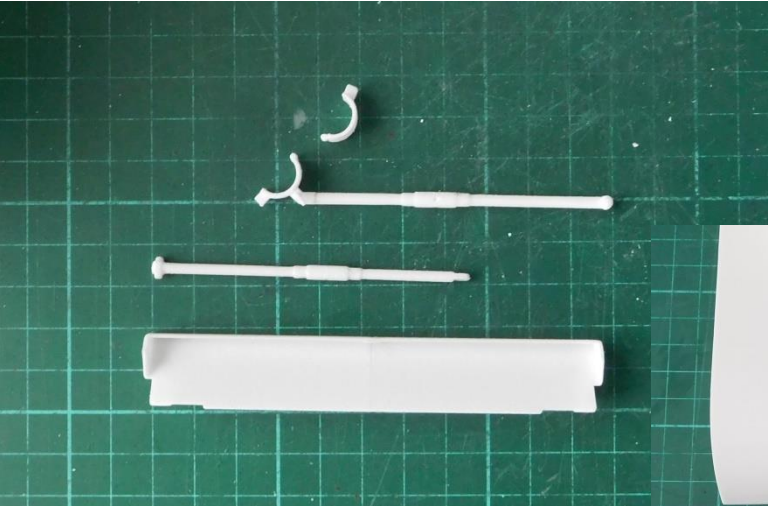

Kettenantrieb / gear drives

Getriebemotor / gear drive Ø28mm / 12V / 400RPM

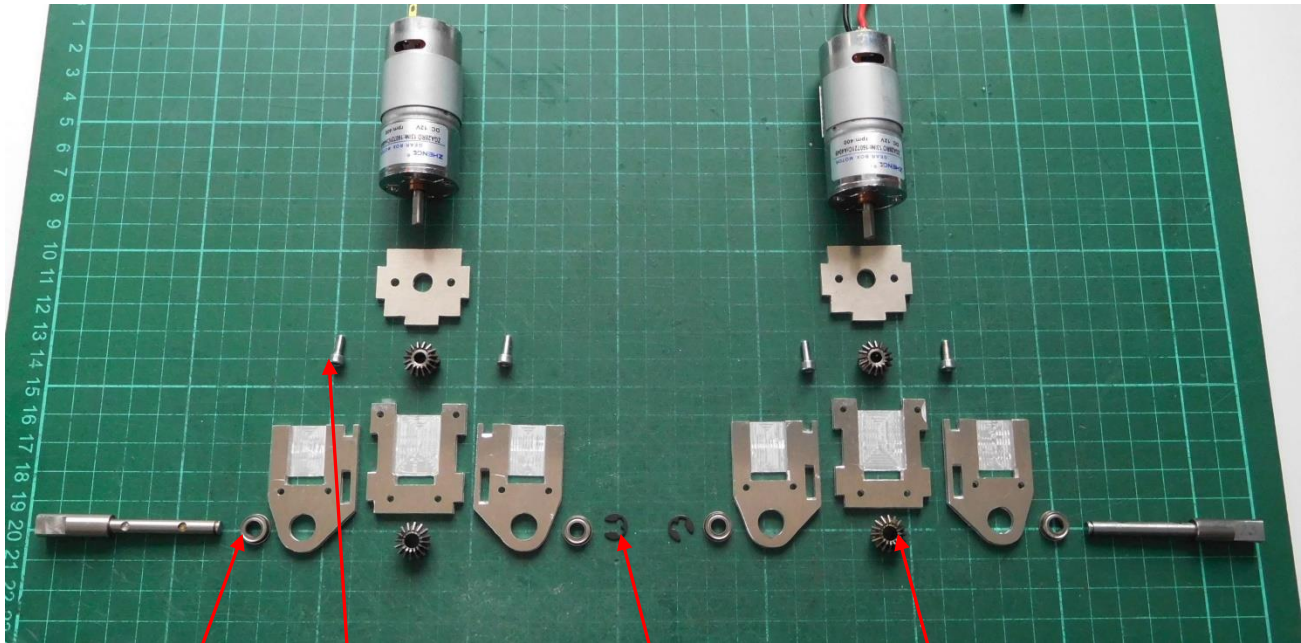

Bundlager /
flange ball
bearing
Ø5/Ø9x3

M3x6

Sicherungsring /
snap ring Ø4.3mm

Kegelrad /
bevel gear
m0.7 z16 1:1 b5

Aluplatten zusammenkleben /
glueing all aluminum parts

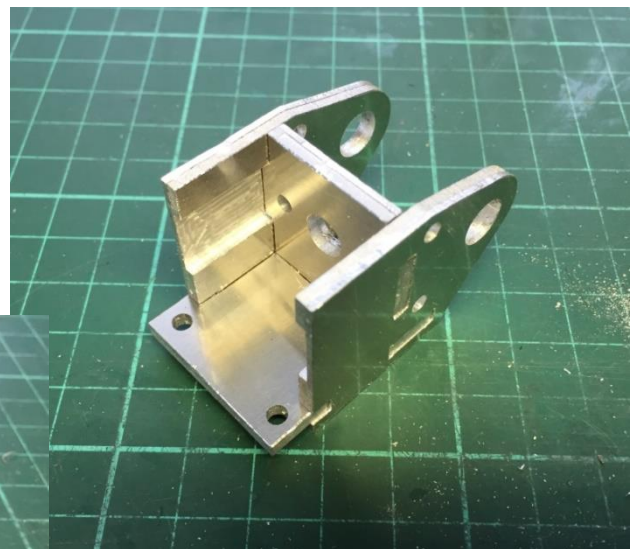
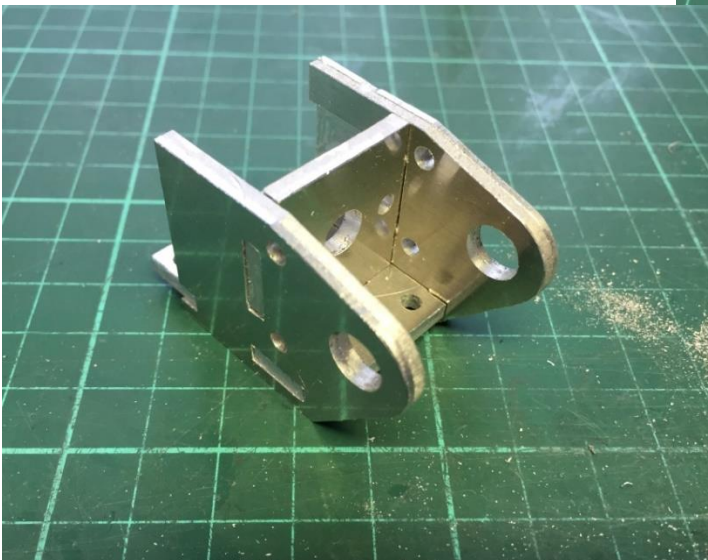



M1.2x4(6)



**DKLM Ketten /
DKLM tracks
38t tracks**

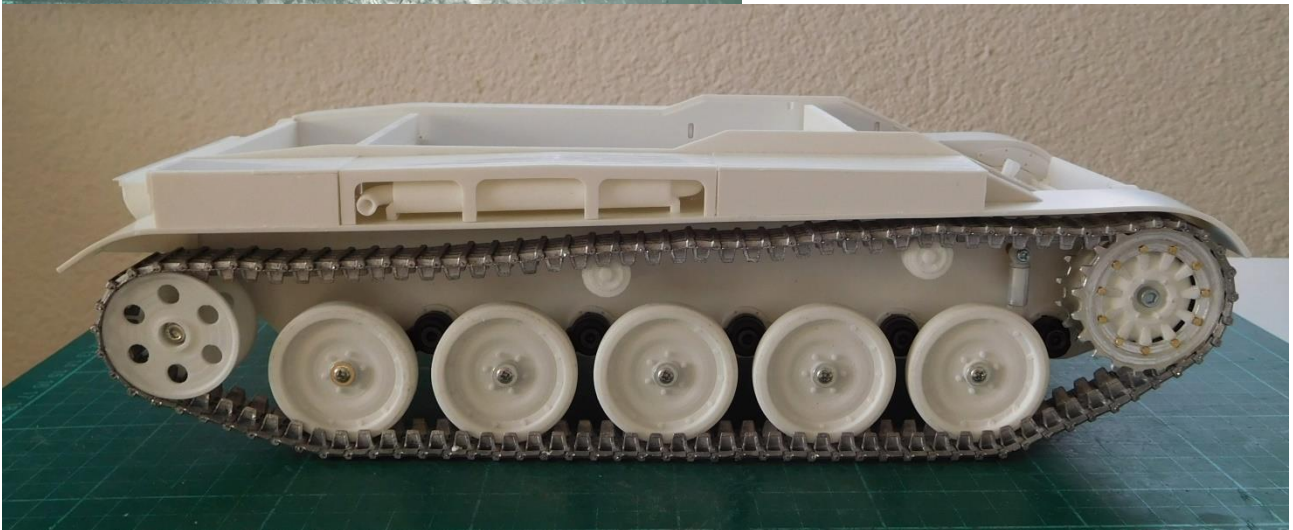

Oberwanne / upper hull

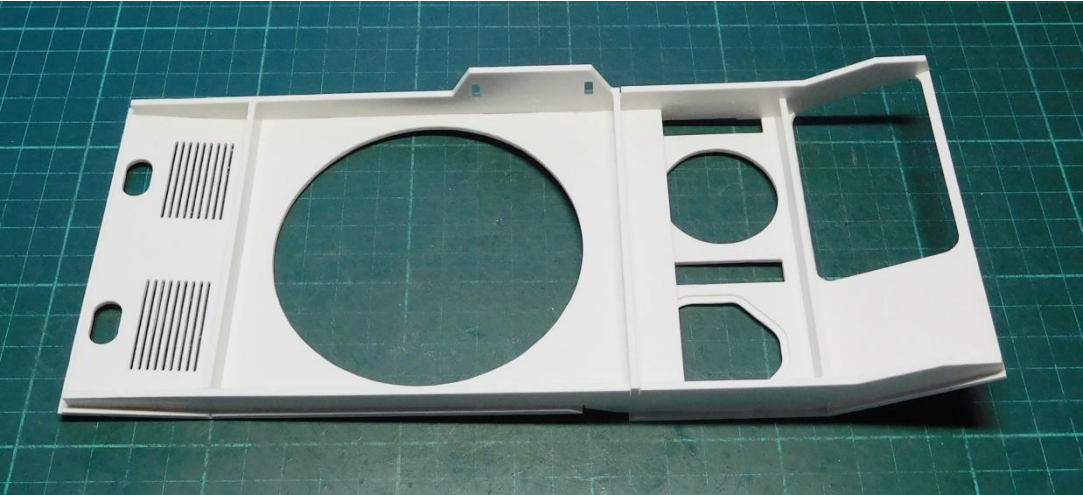
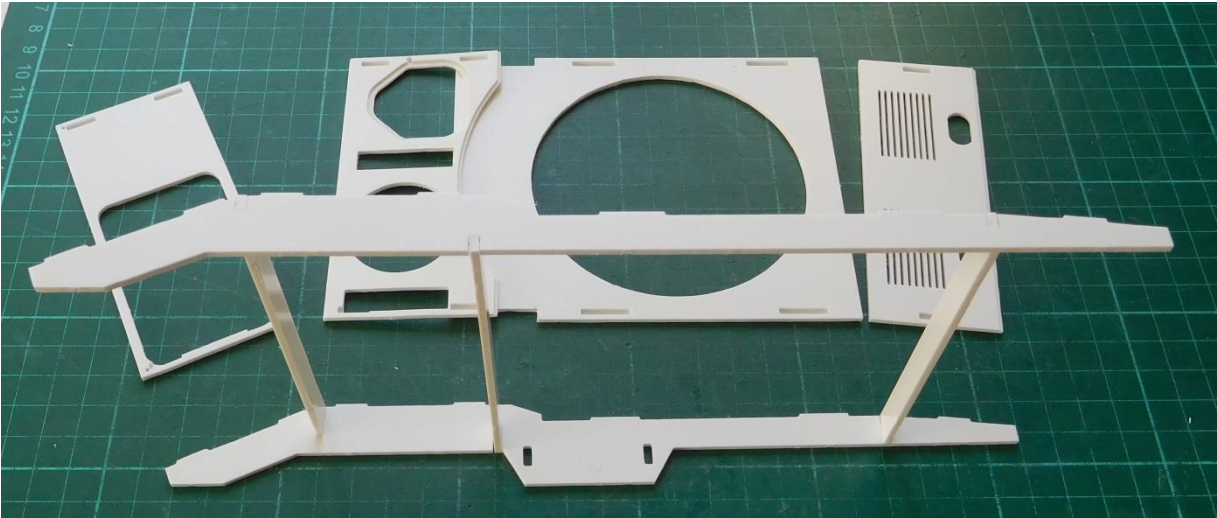
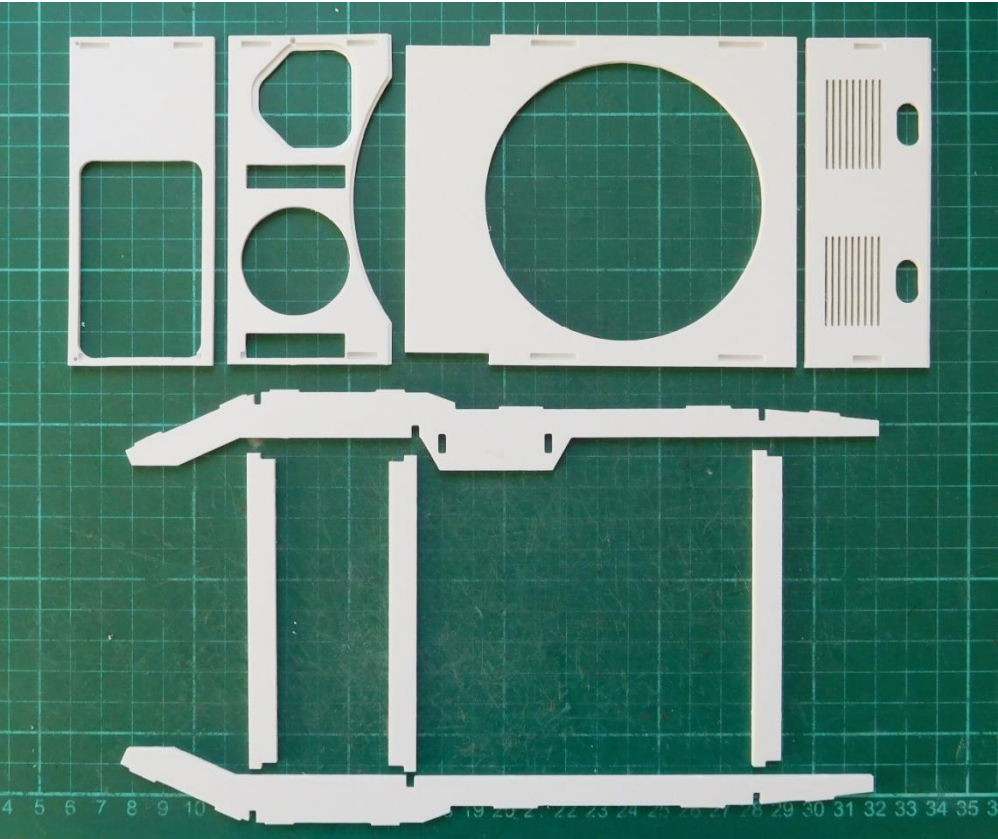

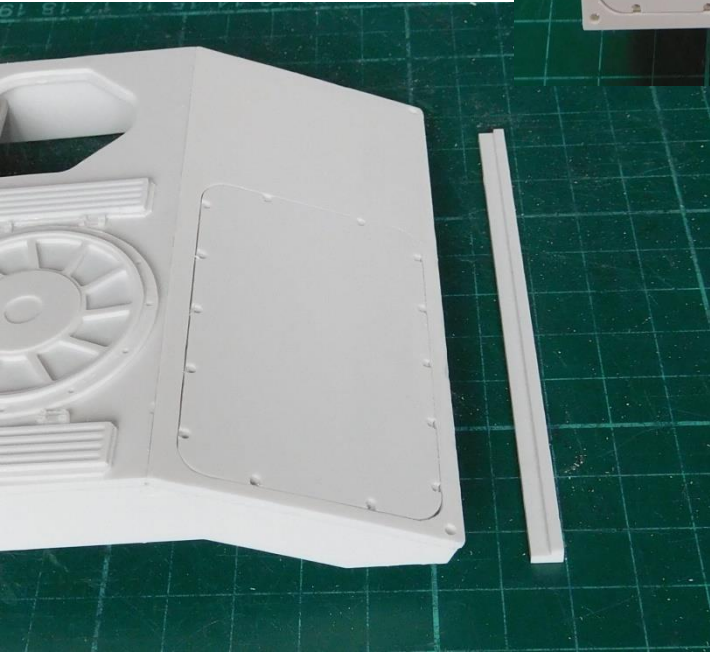
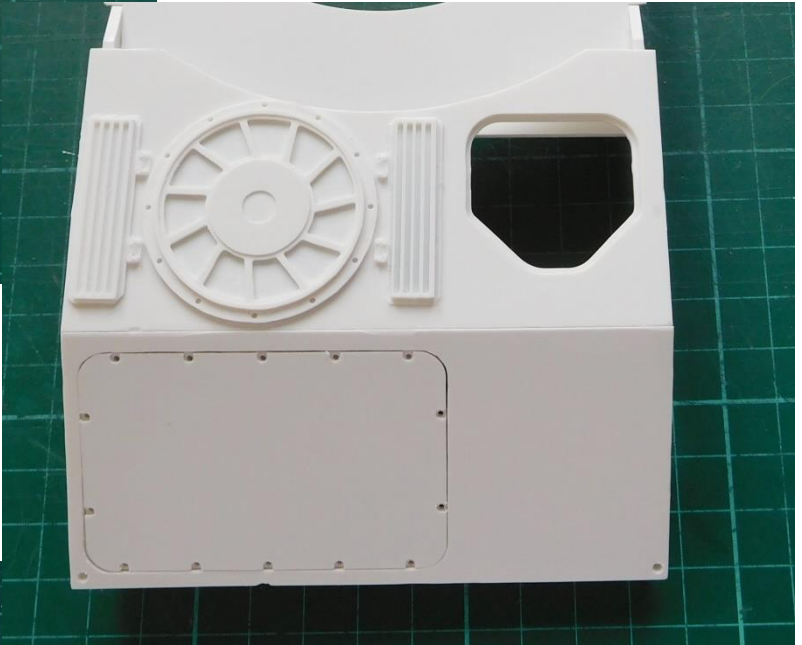
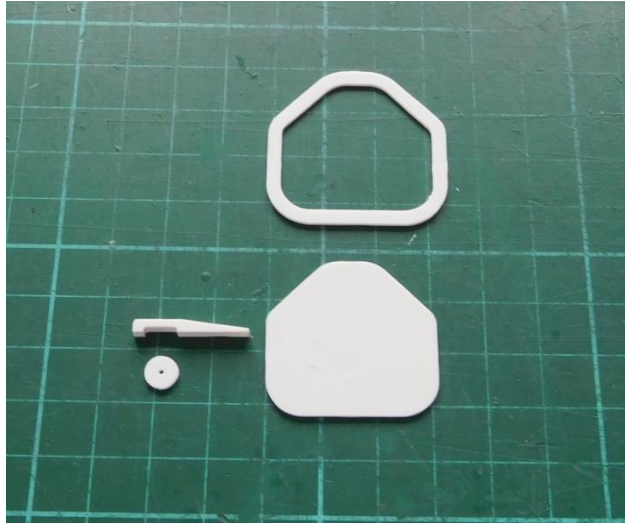
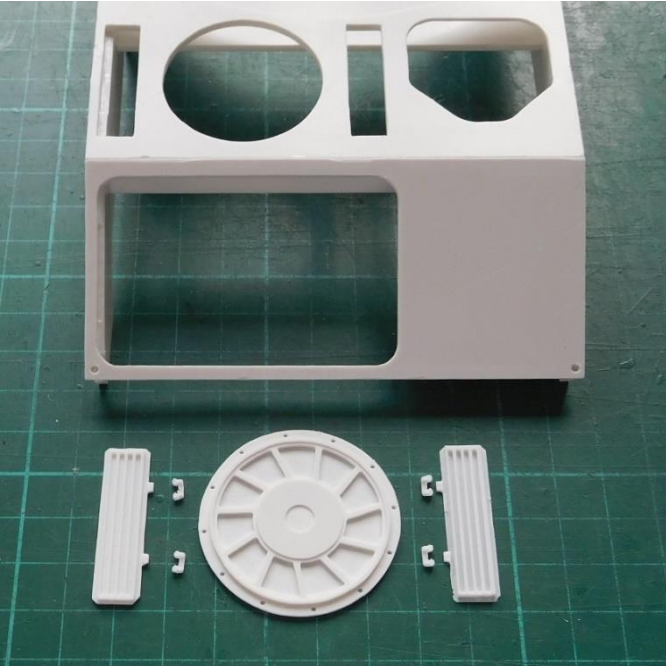

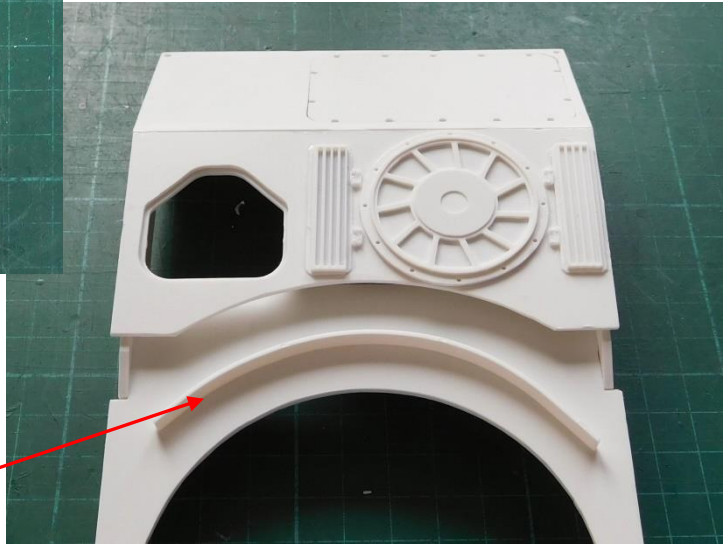
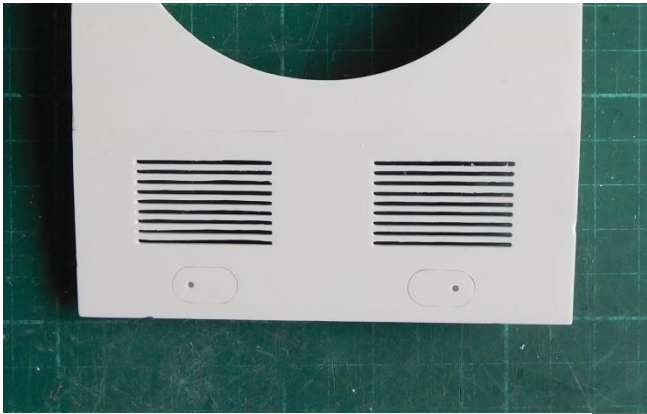

runden / bending

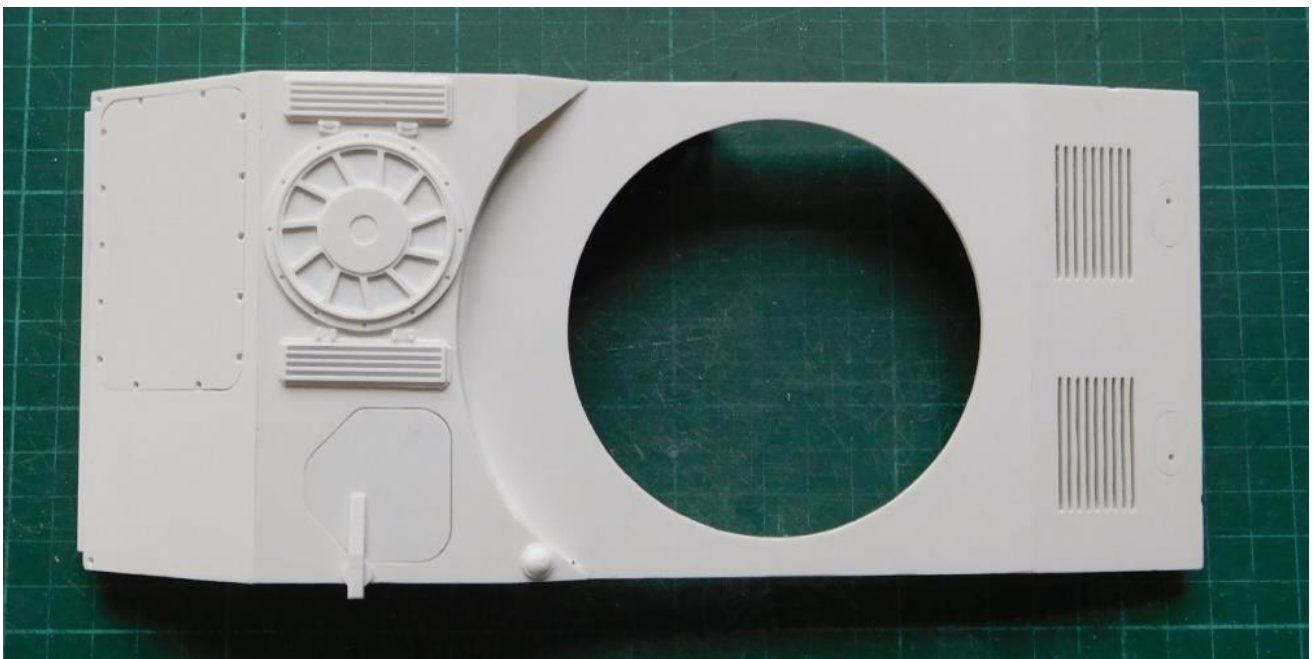
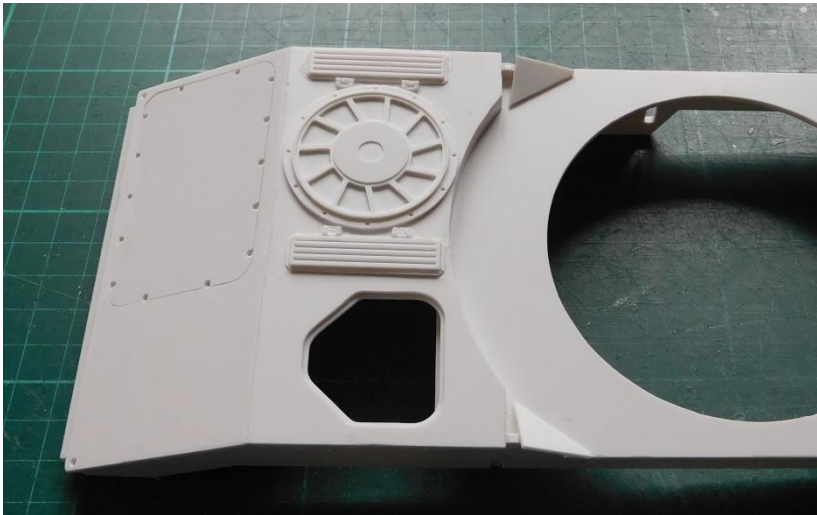

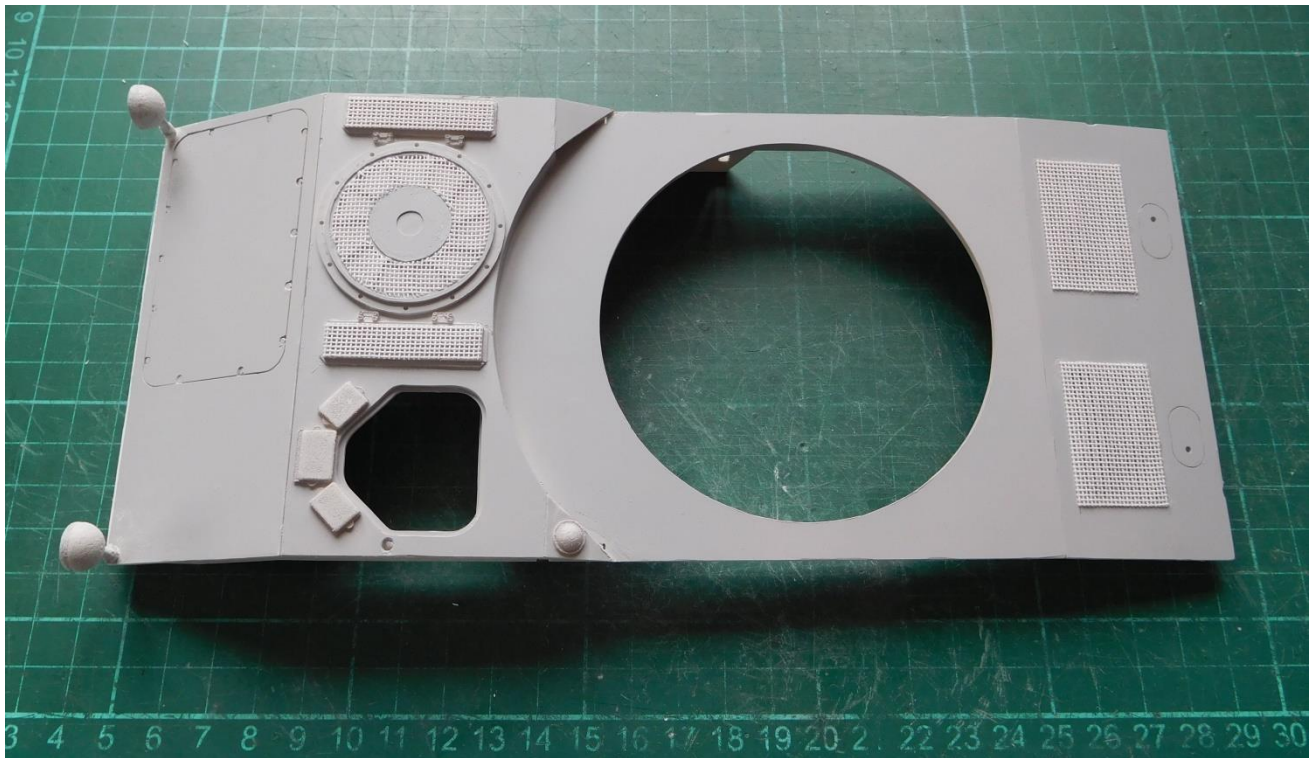
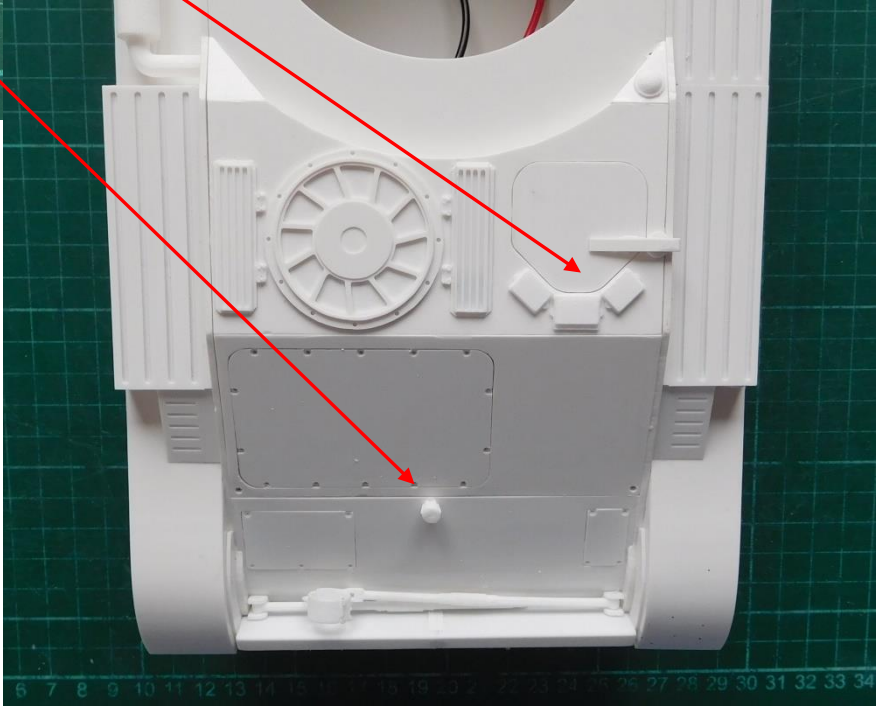
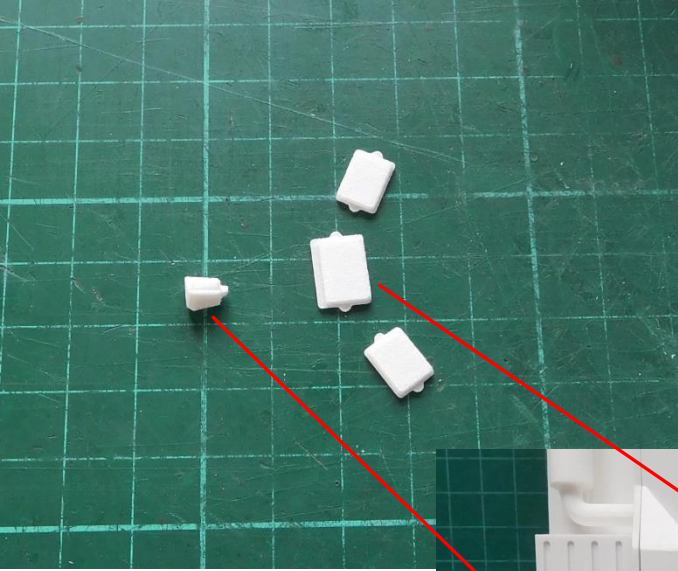

Turm (drehender Teil) / rotating turret part

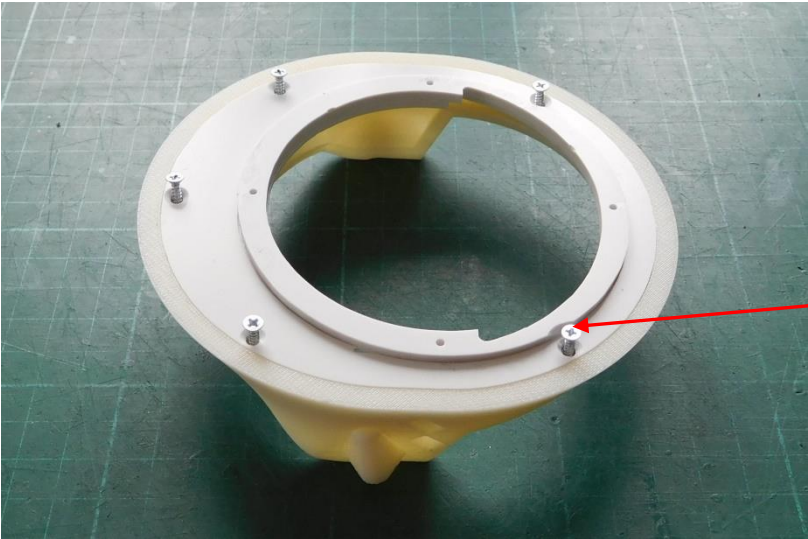
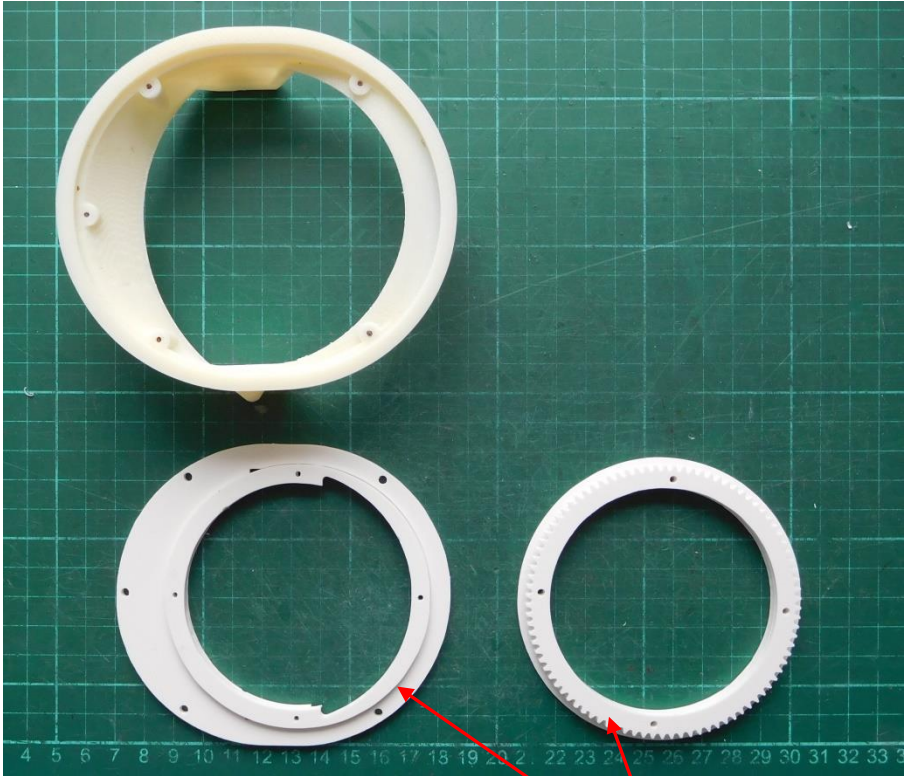
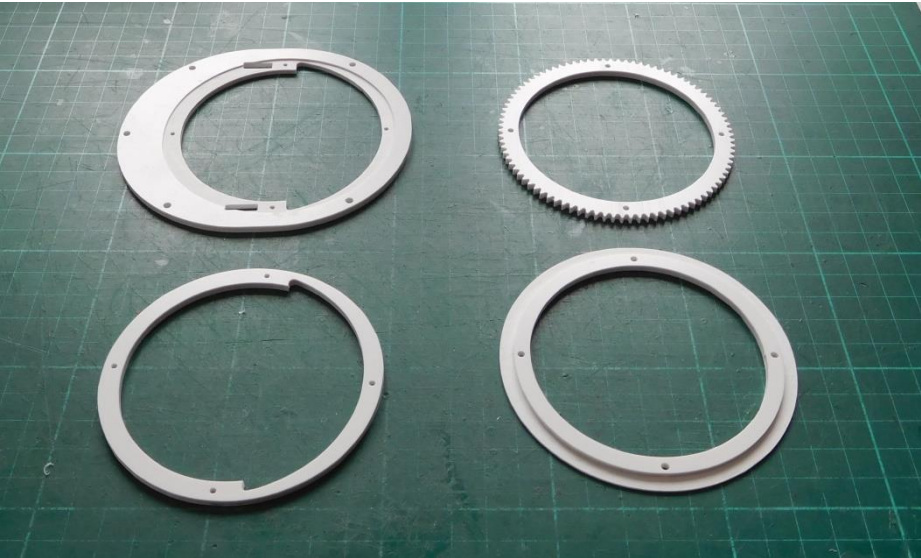

**Nicht kleben!
No glue!**

**Blechschaube /
countersunk screw
Ø2.2x13**

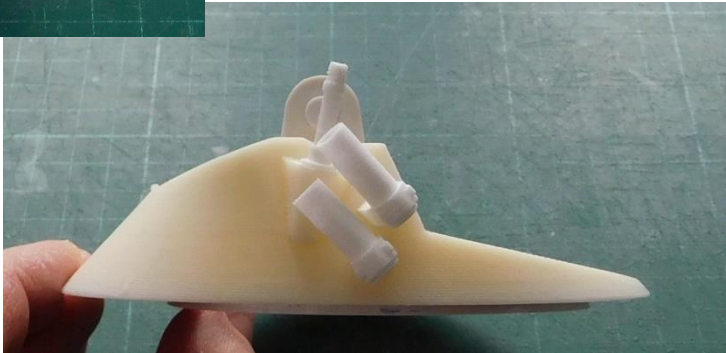
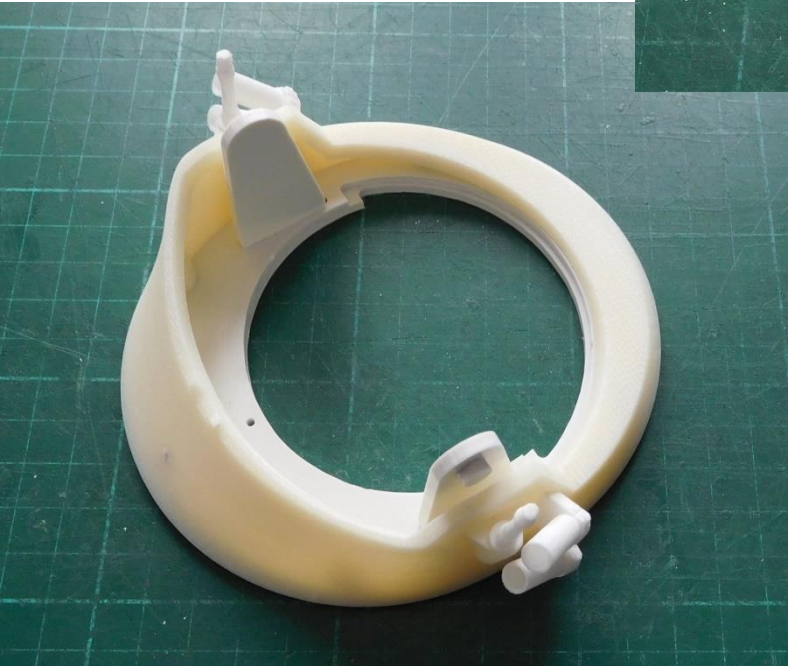
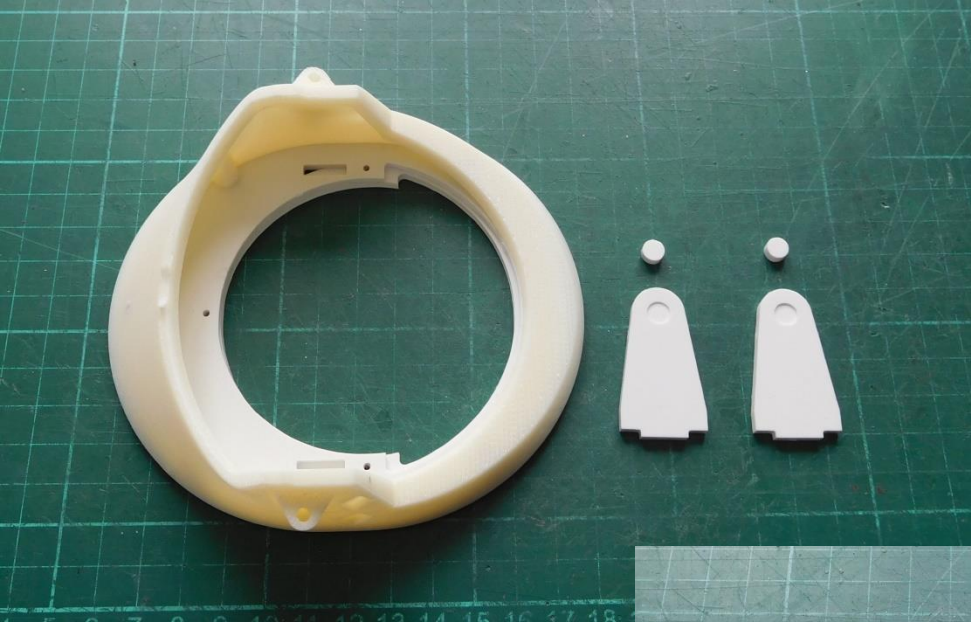

Turm (oszillierender Teil) / oscillating turret part

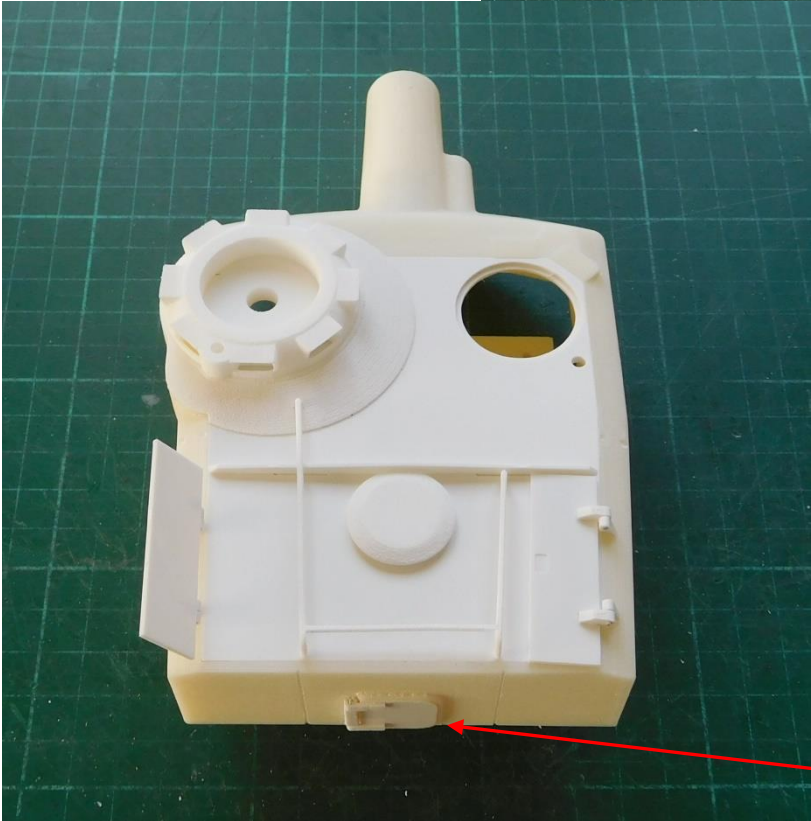
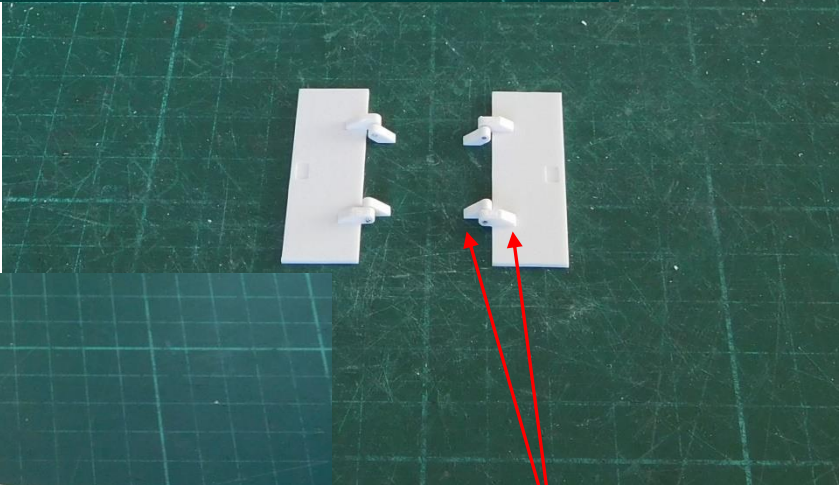
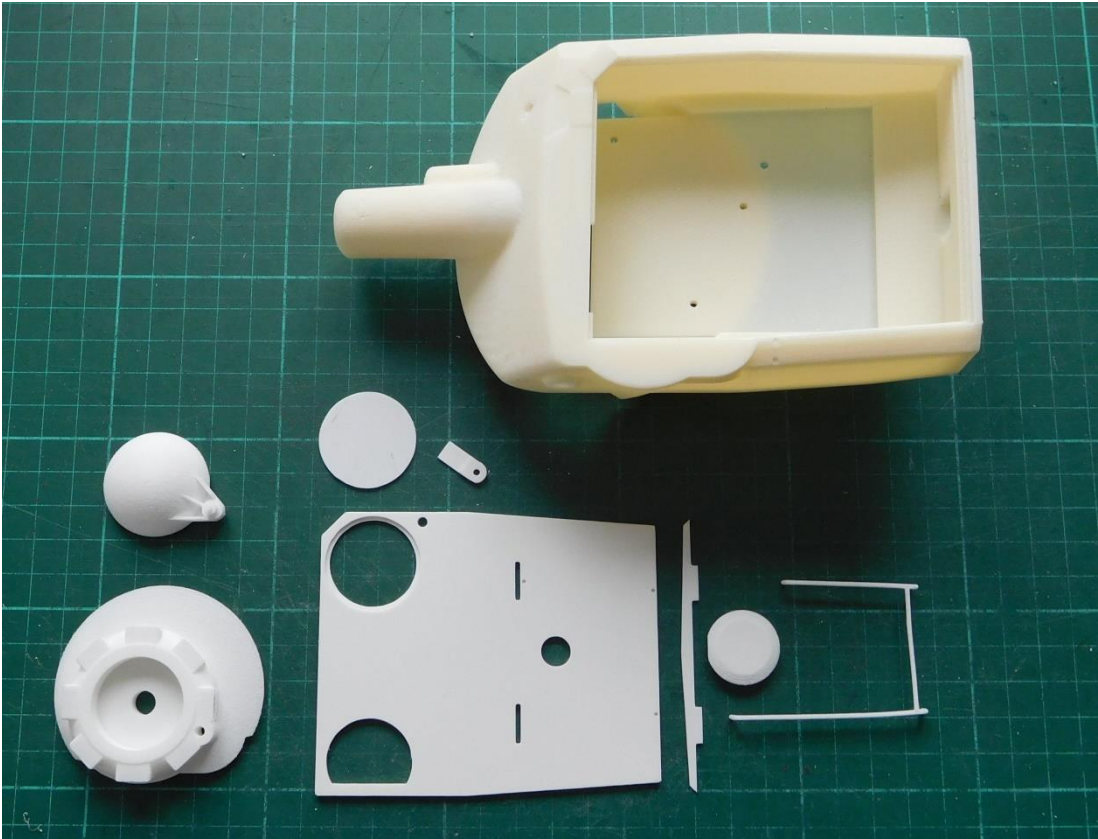

**Unterschiedliche
Scharnierteile /
different hinges parts**



**Nicht kleben!
No glue!**

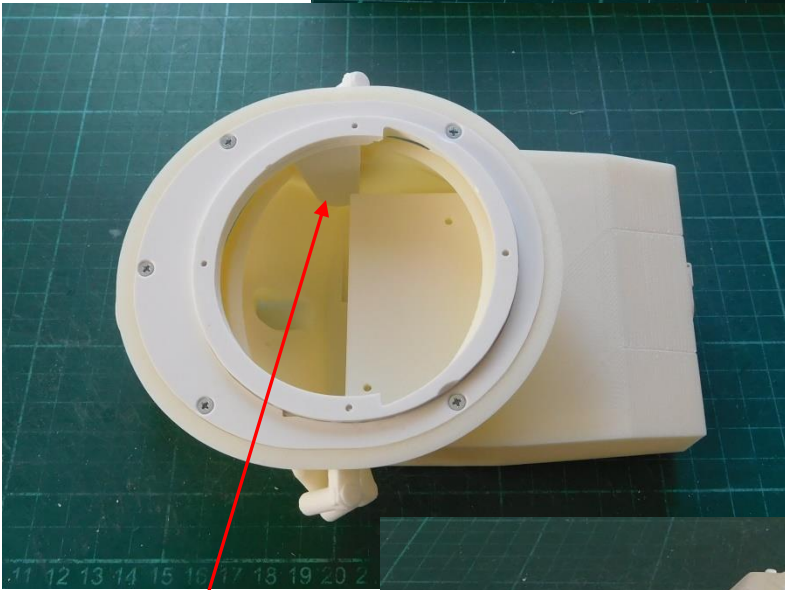
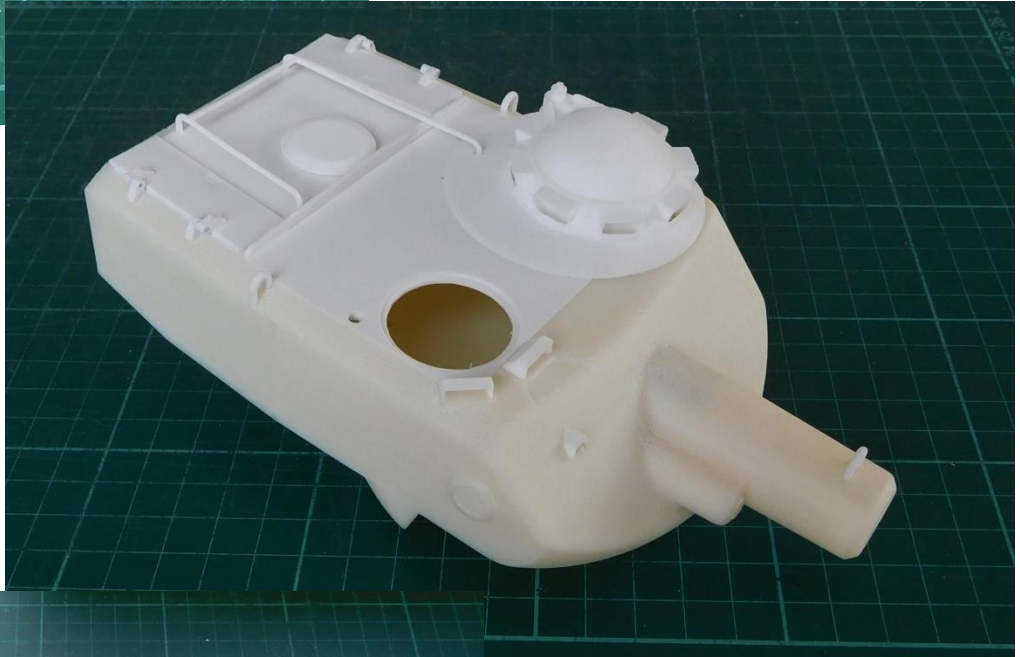

Nicht kleben!
No glue!

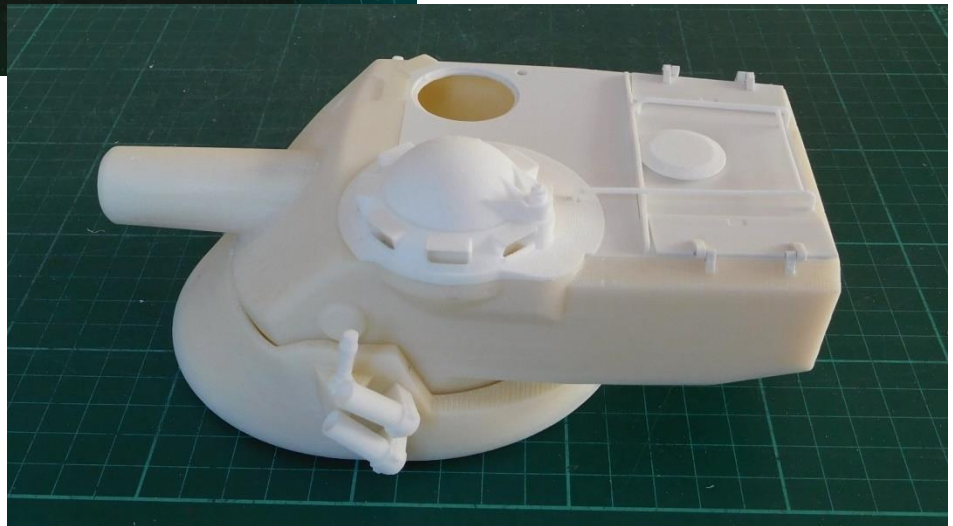

HL Panther G Kanonenrohr / HL Panther G gun tube

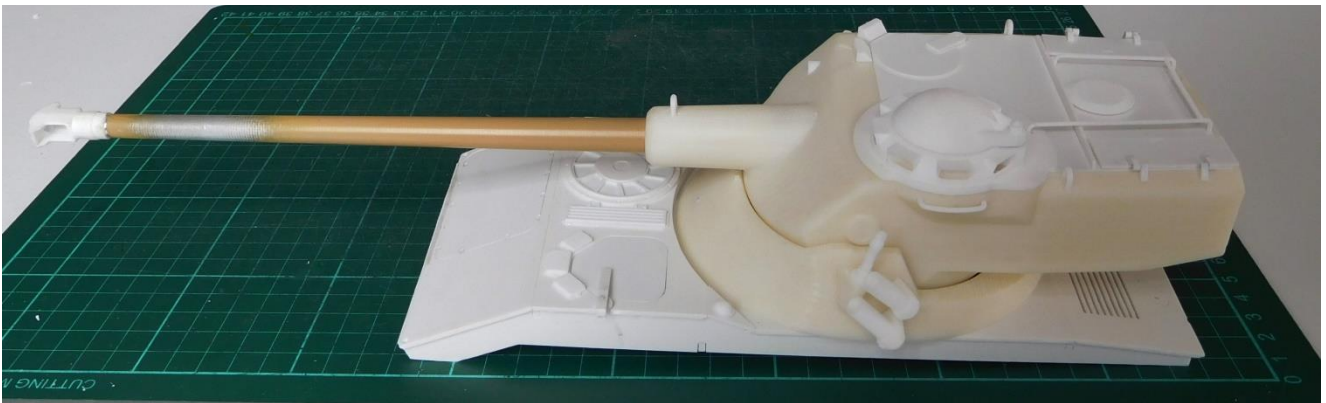
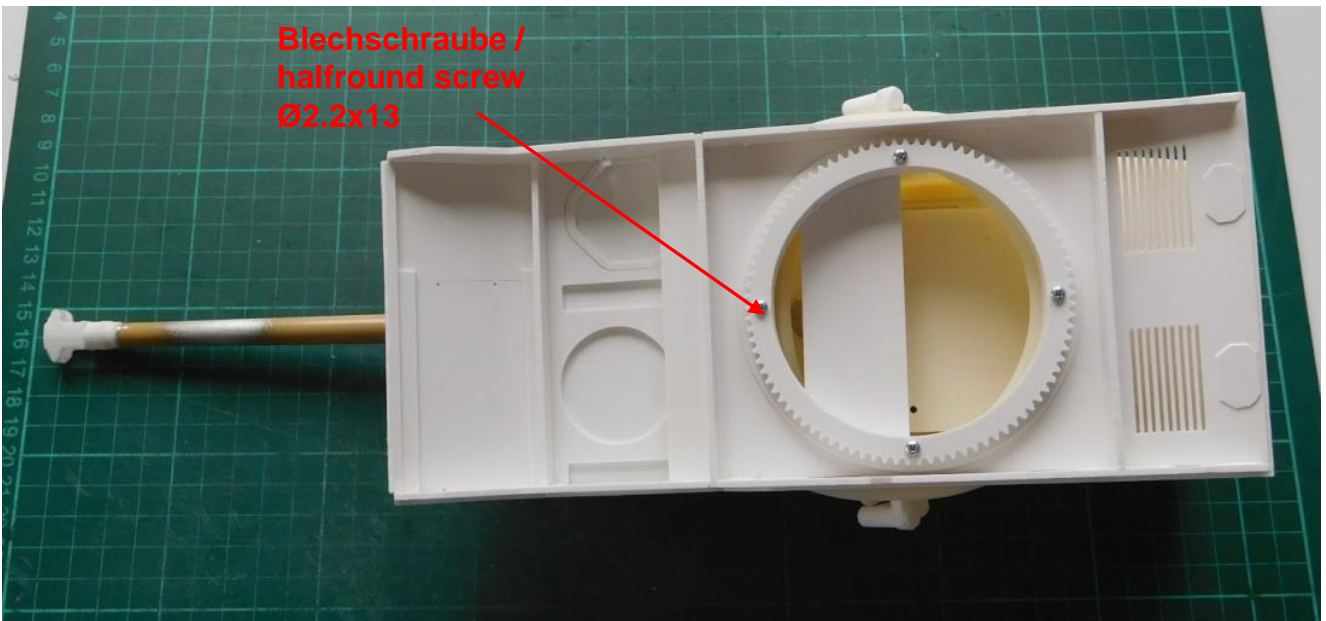

Fertiges Modell / finished kit

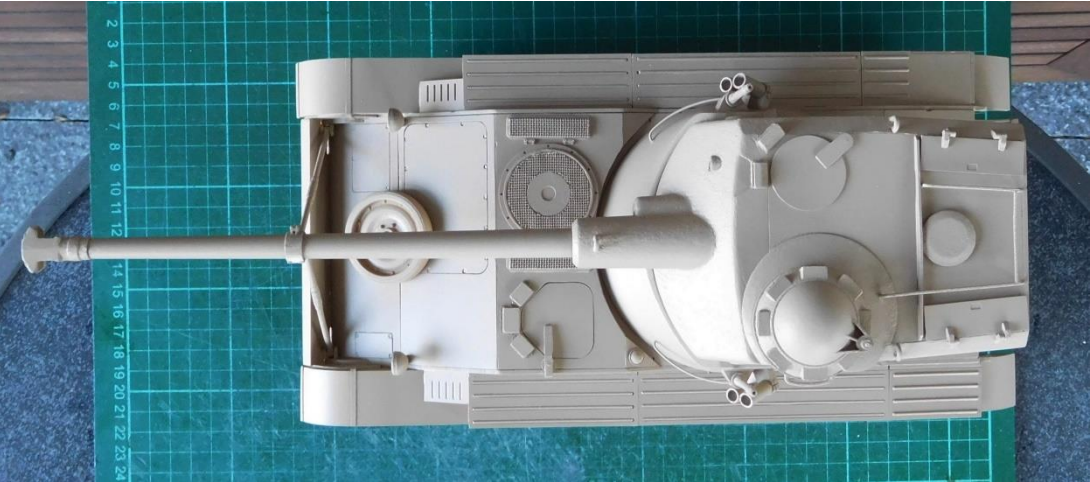
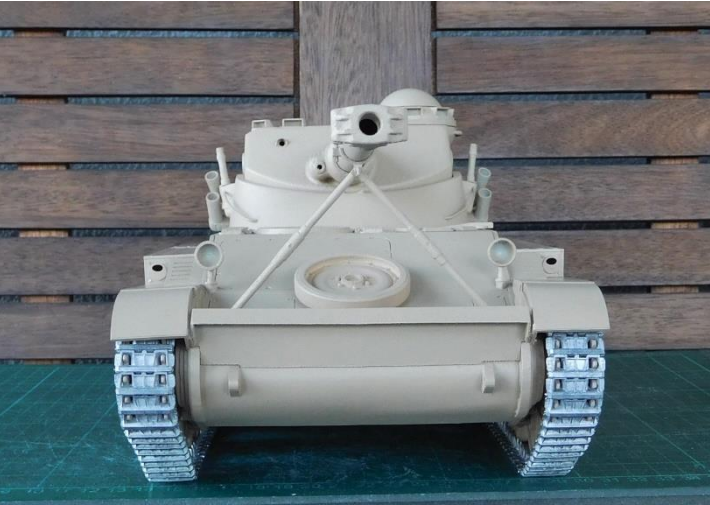



erstellt durch / created by
Freddy